

50FWC V SERIES 50 HZ

FEATURES & BENEFITS

APPLICATIONS



Pumping of clear non-loaded fluids



Extraction of water from ponds, streams or pits and for rainwater collection



Wastewater



MARKETS



CAST IRON SUBMERSIBLE WASTEWATER LIFT PUMPS

Submersible electric pumps suitable for pumping screened waste water, draining the sewage of blocks of flats and houses and flooded premises in general.

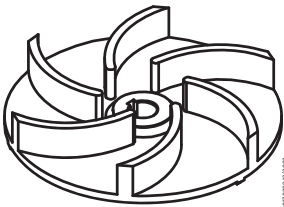

VORTEX IMPELLER

GENERAL FEATURES

		Materials/Constr.design
Vortex impeller		Cast iron EN GJL200
External casing		Cast iron EN GJL200
Pump body		Cast iron EN GJL200
Cover		Cast iron EN GJL200
Mechanical seal		Silicon carbide (SiC/SiC)
Motor shaft		Stainless steel AISI416
Power cable	Type	10 m H07RN-F type
	Single-phase	4G1,5mm ² , capacitor box and SCHUKO plug (CEE 7/VII)
	Single-phase 50FWC-V-52-1,6M	4G2,5mm ² , capacitor box and SCHUKO plug (CEE 7/VII)
	Three-phase	4G1,5mm ²
		Motor
Constr.design		asynchronous squirrel cage-type oil filled
Type		2 poles; 50 Hz
Insulation class		F
Protection degree		IP68
Voltage	Single-phase	230V ±6% built-in overheating protection (up to 1,1 kW), float switch as optional capacitor box and SCHUKO plug (CEE 7/VII)
	Three-phase	230V ±10%, 400V ±10%
		Limits of use
Maximum liquid temperature		+40 °C
pH of pumped liquid		6 - 10
Liquid density		1,0 kg/dm ³
Maximum immersion depth:		5 m
Min. immersion depth for continuous service		
50FWC-V-52-0,9M/T, 50FWC-V-52-1,1M/T		353 mm
50FWC-V-52-1,6M/T		380 mm
Free passage	50FWC-V-52-0,9M/T, 50FWC-V-52-1,1M/T	40 mm
	50FWC-V-52-1,6M/T	50 mm
Max. number of starting/hour		20
		Construction options

- 60 Hz version
- Different voltages
- Food-grade white oil

DIMENSIONAL DRAWINGS

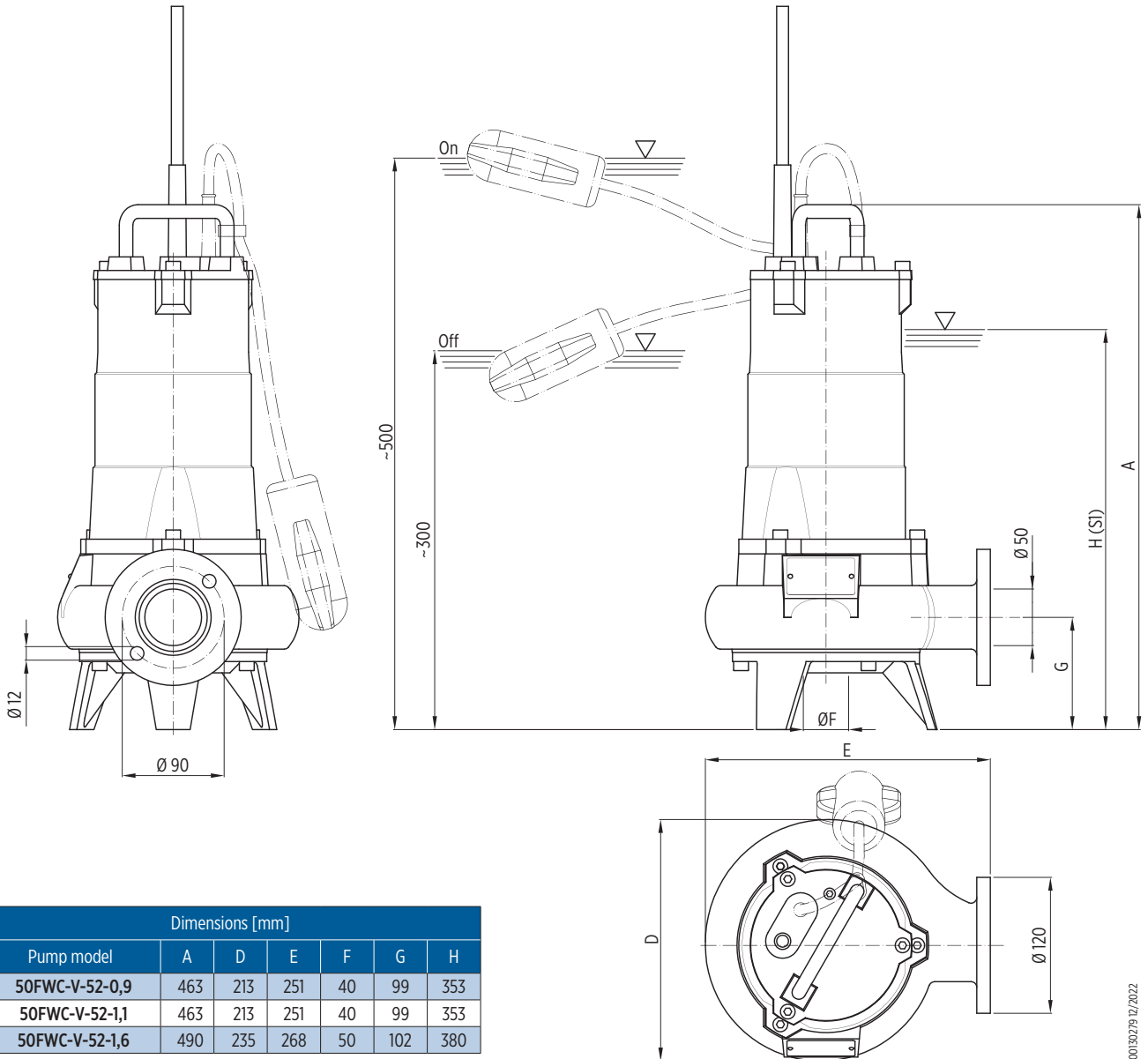

Dimensions [mm]						
Pump model	A	D	E	F	G	H
50FWC-V-52-0,9	463	213	251	40	99	353
50FWC-V-52-1,1	463	213	251	40	99	353
50FWC-V-52-1,6	490	235	268	50	102	380

Packaging		
Pump model	Dimensions [mm]	Weight [kg]
50FWC-V-52-0,9	290x245x585	30
50FWC-V-52-1,1	290x245x585	30
50FWC-V-52-1,6	300x260x585	36

00130279 12/2022

TECHNICAL DATA

Pump model	Motor absorbed power P ₁	Rated power P ₂		Voltage	Rated current	Phase	Power cable		float switch	Running capacitor	Delivery port	Weight [kg]
	[kW]	[kW]	[HP]	[V]	[A]		length [m]	Type		[µf]		
50FWC-V-52-0,9M	1,3	0,9	1,2	230	5,8	1 ~	10	4G1,5	-	25	G2 (Ø50)	29
50FWC-V-52-0,9M-G	1,3	0,9	1,2	230	5,8	1 ~	10	4G1,5	•	25	G2 (Ø50)	29
50FWC-V-52-0,9T	1,3	0,9	1,2	400	2	3 ~	10	4G1,5	-	-	G2 (Ø50)	29
50FWC-V-52-0,9T-G	1,3	0,9	1,2	400	2	3 ~	10	4G1,5	•	-	G2 (Ø50)	29
50FWC-V-52-1,1M	1,7	1,1	1,5	230	7	1 ~	10	4G1,5	-	30	G2 (Ø50)	29
50FWC-V-52-1,1M-G	1,7	1,1	1,5	230	7	1 ~	10	4G1,5	•	30	G2 (Ø50)	29
50FWC-V-52-1,1T	1,7	1,1	1,5	400	3	3 ~	10	4G1,5	-	-	G2 (Ø50)	29
50FWC-V-52-1,1T-G	1,7	1,1	1,5	400	3	3 ~	10	4G1,5	•	-	G2 (Ø50)	29
50FWC-V-52-1,6M	2,3	1,6	2,1	230	9,1	1 ~	10	4G2,5	-	40	G2 (Ø50)	35
50FWC-V-52-1,6M-G	2,3	1,6	2,1	230	9,1	1 ~	10	4G2,5	•	40	G2 (Ø50)	35
50FWC-V-52-1,6T	2,3	1,6	2,1	400	4	3 ~	10	4G1,5	-	-	G2 (Ø50)	35
50FWC-V-52-1,6T-G	2,3	1,6	2,1	400	4	3 ~	10	4G1,5	•	-	G2 (Ø50)	35

"-" = not available

• = available

HYDRAULIC PERFORMANCE AT 50 HZ

Pump model	Phase	Q = Delivery										
		l/sec 0	1	2	3	4	5	6	7	8	9	10
		m ³ /h 0	3,6	7,2	10,8	14,4	18	21,6	25,2	28,8	32,4	36
		US gpm 0	15,8	31,7	47,5	63,4	79,2	92,1	110,9	126,8	142,6	158,5
		H = Total meters head of water column [m]										
50FWC-V-52-0,9	1 ~	12,2	11	9,8	8,5	7,4	6	4,3	2,3			
	3 ~	12,2	11	9,8	8,5	7,4	6	4,3	2,3			
50FWC-V-52-1,1	1 ~	13	12	11	9,5	8,3	7	5,7	4,4	3	1,6	
	3 ~	13	12	11	9,5	8,3	7	5,7	4,4	3	1,6	
50FWC-V-52-1,6	1 ~	14	12,5	11,5	10,5	9,6	8,7	7,8	6,8	5,5	4	2,1
	3 ~	14	12,5	11,5	10,5	9,6	8,7	7,8	6,8	5,5	4	2,1

HYDRAULIC PERFORMANCE AT 50 HZ

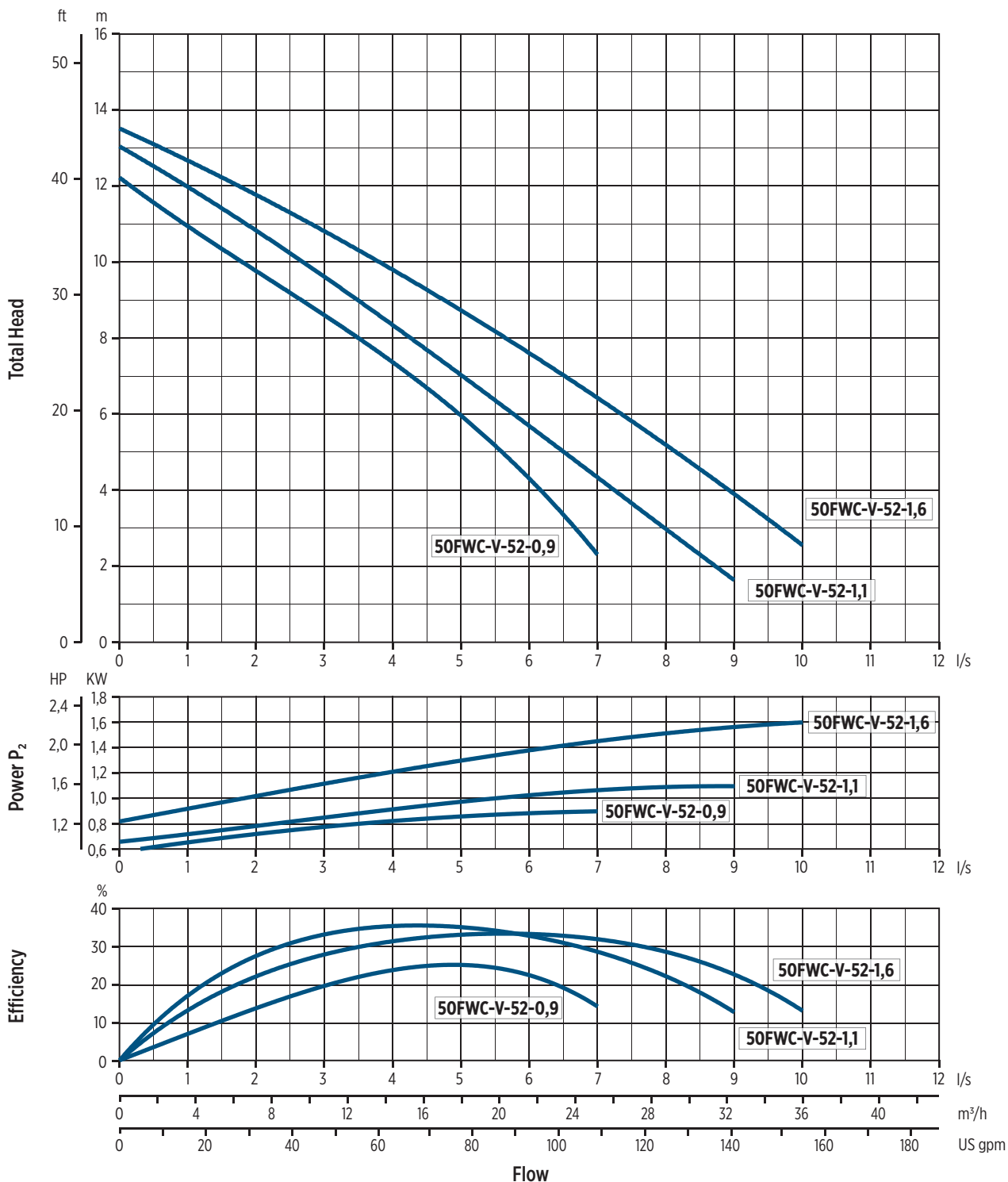

0020095 12/2022

INSTALLATION

INSTALLATION INSTRUCTIONS

PERMANENT INSTALLATION WITH COUPLING SYSTEM

It is the recommended installation for the permanent pumping station. The electric pump is guided by two pipes and it is connected automatically to the coupling system. The quick connection ensures that the pump can be easily removed and re-installed.

TRANSPORTABLE INSTALLATION

Transportable as emergency pump with connection to the hose and for free installation in the well.

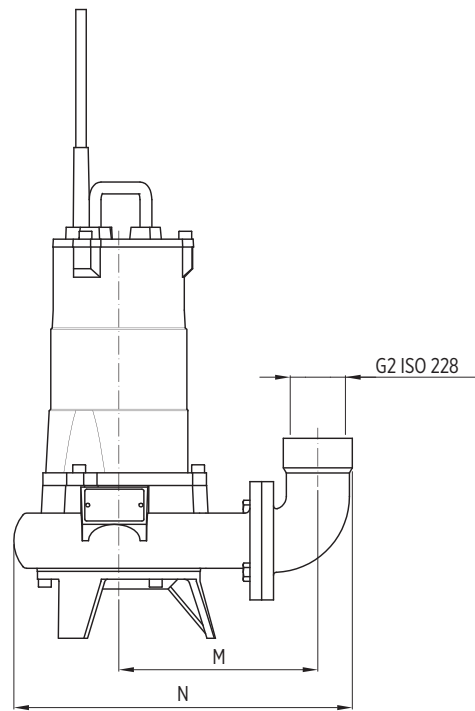
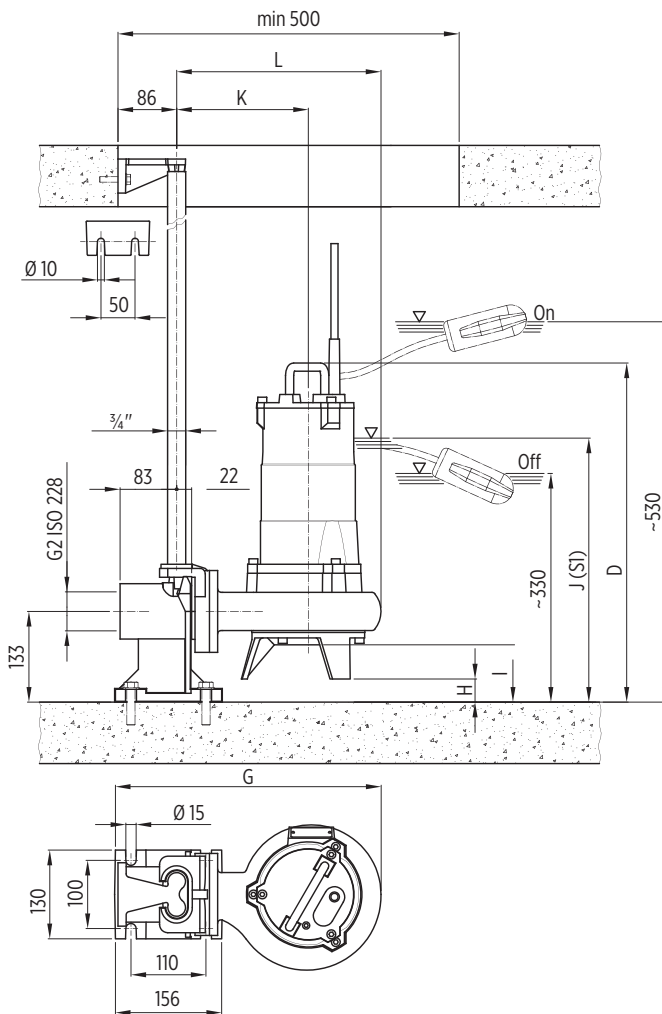

00130279/12/2022

Installation Dimensions [mm]

Pump model	D	G	H	I	J	K	L	M	N
50FWC-V-52-0,9	497	390	34	84	387	193	300	202	344
50FWC-V-52-1,1	497	390	34	84	387	193	300	202	344
50FWC-V-52-1,6	521	407	31	81	414	200	316	209	360

50FWC M SERIES 50 HZ

FEATURES & BENEFITS

APPLICATIONS



Pumping of clear non-loaded fluids



Extraction of water from ponds, streams or pits and for rainwater collection



Wastewater



MARKETS



CAST IRON SUBMERSIBLE WASTEWATER LIFT PUMPS

Submersible electric pumps suitable for pumping screened waste water, draining the sewage of blocks of flats and houses and flooded premises in general.

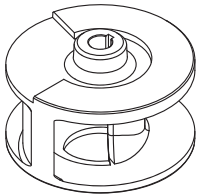

0000017/2022

SINGLE-CHANNEL IMPELLER

GENERAL FEATURES

		Materials/Constr.design
Single-channel impeller		Cast iron EN GJL200
External casing		Cast iron EN GJL200
Pump body		Cast iron EN GJL200
Cover		Cast iron EN GJL200
Mechanical seal		Silicon carbide (SiC/SiC)
Motor shaft		Stainless steel AISI416
Power cable	Type	10 m H07RN-F type
	Single-phase	4G1,5mm ² , capacitor box and SCHUKO plug (CEE 7/VII)
	Single-phase 50FWC-M-52-1,6M	4G2,5mm ² , capacitor box and SCHUKO plug (CEE 7/VII)
	Three-phase	4G1,5mm ²
		Motor
Constr.design		asynchronous squirrel cage-type oil filled
Type		2 poles; 50 Hz
Insulation class		F
Protection degree		IP68
Voltage	Single-phase	230V ±6% built-in overheating protection, float switch as optional capacitor box and SCHUKO plug (CEE 7/VII)
	Three-phase	230V ±10%, 400V ±10%
		Limits of use
Maximum liquid temperature		+40 °C
pH of pumped liquid		6 - 10
Liquid density		1,0 kg/dm ³
Maximum immersion depth:		5 m
Min. immersion depth for continuous service		
50FWC-M-52-0,9M/T, 50FWC-M-52-1,1M/T		353 mm
50FWC-M-52-1,6M/T, 50FWC-M-52-1,6T-HH		380 mm
Free passage	50FWC-M-52-0,9M/T, 50FWC-M-52-1,1M/T	40 mm
	50FWC-M-52-1,6M/T, 50FWC-M-52-1,6T-HH	50 mm
Max. number of starting/hour		20
		Construction options

- 60 Hz version
- Different voltages
- Food-grade white oil

DIMENSIONAL DRAWINGS

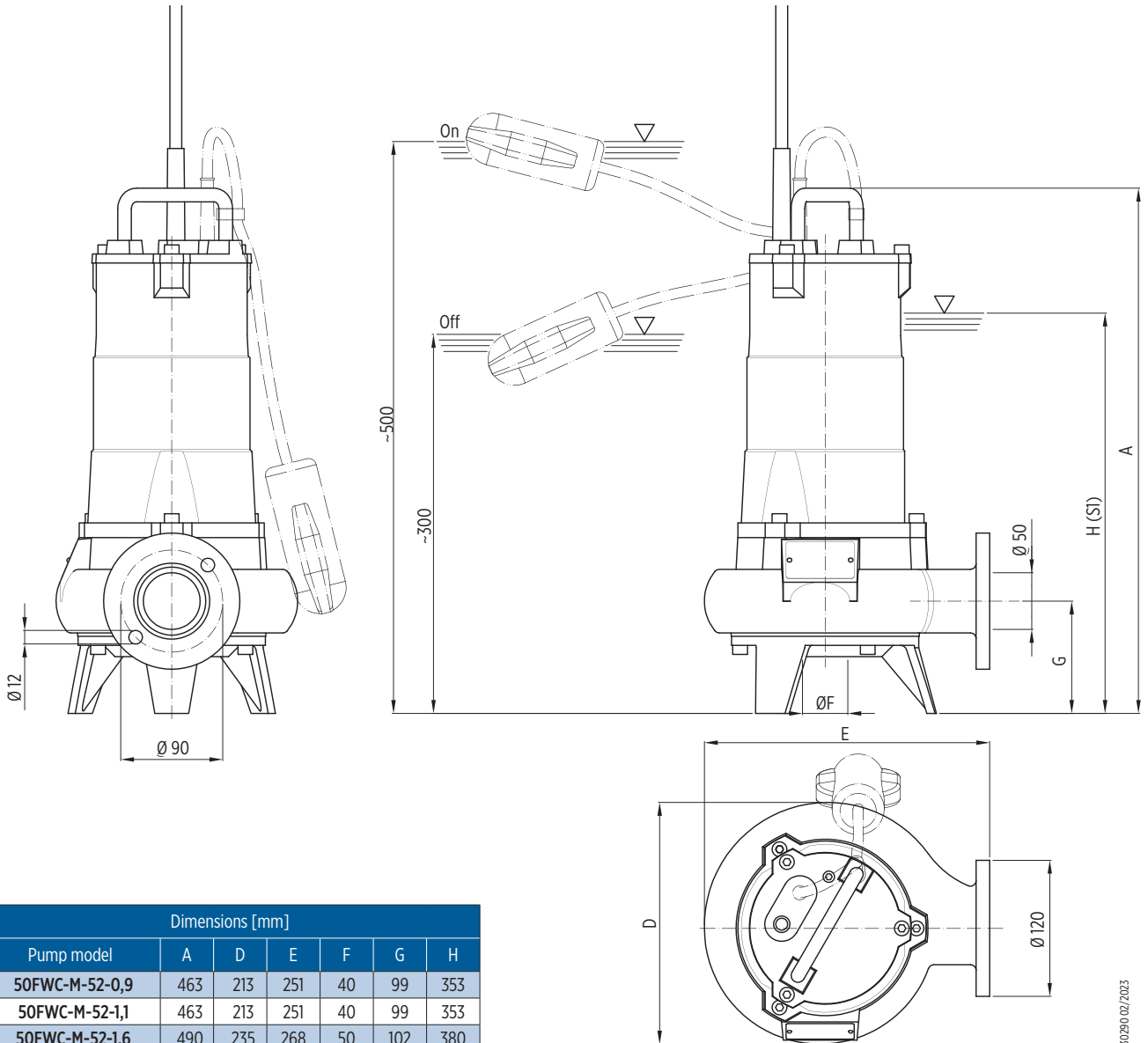

00150290 02/2023

Dimensions [mm]

Pump model	A	D	E	F	G	H
50FWC-M-52-0,9	463	213	251	40	99	353
50FWC-M-52-1,1	463	213	251	40	99	353
50FWC-M-52-1,6	490	235	268	50	102	380

Packaging

Pump model	Dimensions [mm]	Weight [kg]
50FWC-M-52-0,9	290x245x585	31
50FWC-M-52-1,1	290x245x585	31
50FWC-M-52-1,6	300x260x585	35

TECHNICAL DATA

Pump model	Motor absorbed power P ₁	Rated power P ₂		Voltage [V]	Rated current [A]	Phase	Power cable		float switch	Running capacitor [µf]	Delivery port	Weight [kg]
	[kW]	[kW]	[HP]				length [m]	Type				
50FWC-M-52-0,9M	1,3	0,9	1,2	230	5,8	1 ~	10	4G1,5	-	25	G2 (Ø50)	30
50FWC-M-52-0,9M-G	1,3	0,9	1,2	230	5,8	1 ~	10	4G1,5	•	25	G2 (Ø50)	30
50FWC-M-52-0,9T	1,3	0,9	1,2	400	2	3 ~	10	4G1,5	-	-	G2 (Ø50)	30
50FWC-M-52-0,9T-G	1,3	0,9	1,2	400	2	3 ~	10	4G1,5	•	-	G2 (Ø50)	30
50FWC-M-52-1,1M	1,7	1,1	1,5	230	7	1 ~	10	4G1,5	-	30	G2 (Ø50)	30
50FWC-M-52-1,1M-G	1,7	1,1	1,5	230	7	1 ~	10	4G1,5	•	30	G2 (Ø50)	30
50FWC-M-52-1,1T	1,6	1,1	1,5	400	3	3 ~	10	4G1,5	-	-	G2 (Ø50)	30
50FWC-M-52-1,1T-G	1,6	1,1	1,5	400	3	3 ~	10	4G1,5	•	-	G2 (Ø50)	30
50FWC-M-52-1,6M	2,3	1,6	2,1	230	11	1 ~	10	4G2,5	-	40	G2 (Ø50)	34
50FWC-M-52-1,6M-G	2,3	1,6	2,1	230	11	1 ~	10	4G2,5	•	40	G2 (Ø50)	34
50FWC-M-52-1,6T	2,2	1,6	2,1	400	4	3 ~	10	4G1,5	-	-	G2 (Ø50)	34
50FWC-M-52-1,6T-HH	2,2	1,6	2,1	400	4,2	3 ~	10	4G1,5	-	-	G2 (Ø50)	34
50FWC-M-52-1,6T-G	2,2	1,6	2,1	400	4	3 ~	10	4G1,5	•	-	G2 (Ø50)	34

“-” = not available

“•” = available

HYDRAULIC PERFORMANCE AT 50 HZ

Pump model	Phase	Q = Delivery													
		l/sec 0	1	2	3	4	5	6	7	8	9	10	12	13	14
		m ³ /h 0	3,6	7,2	10,8	14,4	18	21,6	25,2	28,8	32,4	36	43,2	46,8	50,4
		US gpm 0	15,8	31,7	47,5	63,4	79,2	92,1	110,9	126,8	142,6	158,5	190,2	206	221,9
		H = Total meters head of water column [m]													
50FWC-M-52-0,9	1 ~	15,5	12,5	11	9,5	8,3	7	5,6	4,1	2,5					
	3 ~	15,5	12,5	11	9,5	8,3	7	5,6	4,1	2,5					
50FWC-M-52-1,1	1 ~	17,5	15	13,5	12	10,5	9,4	8	6,5	5	3,4	1,7			
	3 ~	17,5	15	13,5	12	10,5	9,4	8	6,5	5	3,4	1,7			
50FWC-M-52-1,6	1 ~	19	17	15,5	14	13	12	11	10	9,4	8,6	7,7	5,8	4,2	2,5
	3 ~	19	17	15,5	14	13	12	11	10	9,4	8,6	7,7	5,8	4,2	2,5
	3 - HH	24	22	20,5	19	17,5	16,5	15,2	14	13					

HYDRAULIC PERFORMANCE AT 50 HZ

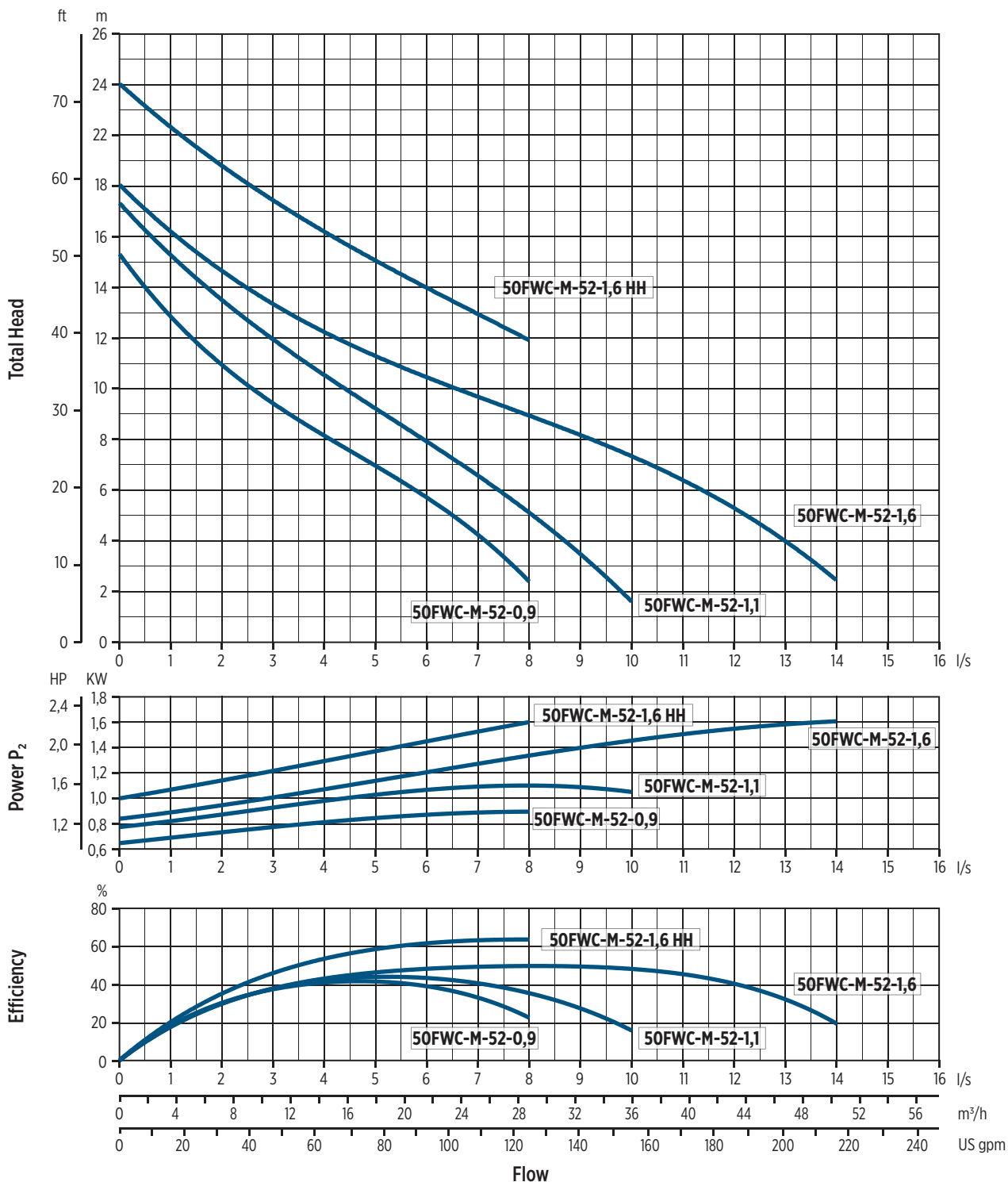

0020105 02/2023

INSTALLATION

INSTALLATION INSTRUCTIONS

PERMANENT INSTALLATION WITH COUPLING SYSTEM

It is the recommended installation for the permanent pumping station. The electric pump is guided by two pipes and it is connected automatically to the coupling system. The quick connection ensures that the pump can be easily removed and re-installed.

TRANSPORTABLE INSTALLATION

Transportable as emergency pump with connection to the hose and for free installation in the well.

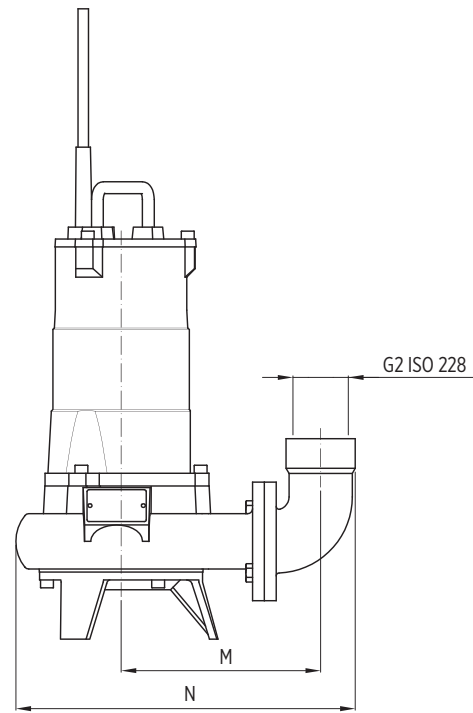
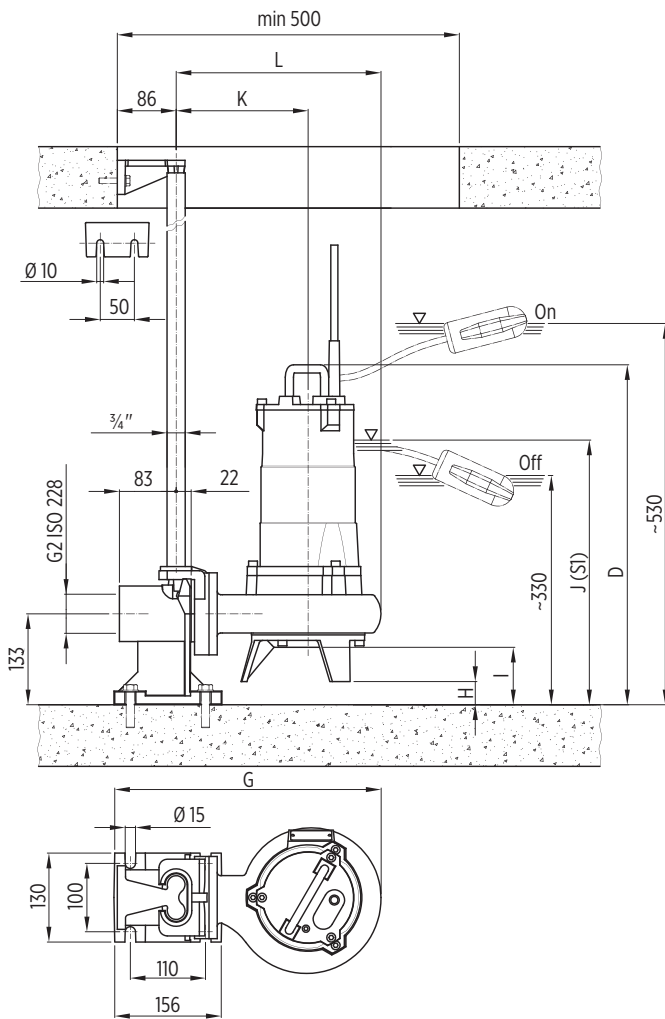

00130290-02/2023

Installation Dimensions [mm]

Pump model	D	G	H	I	J	K	L	M	N
50FWC-M-52-0,9	497	390	34	84	387	193	300	202	344
50FWC-M-52-1,1	497	390	34	84	387	193	300	202	344
50FWC-M-52-1,6	521	407	31	81	414	200	316	209	360

50FWC V4 SERIES 50 HZ

FEATURES & BENEFITS

APPLICATIONS



Pumping of clear non-loaded fluids



Extraction of water from ponds, streams or pits and for rainwater collection



Wastewater



MARKETS



CAST IRON SUBMERSIBLE WASTEWATER LIFT PUMPS

Submersible electric pumps suitable for pumping screened waste water, draining the sewage of blocks of flats and houses and flooded premises in general.

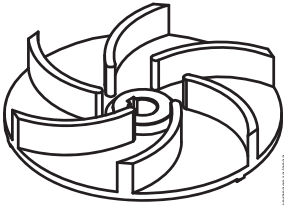

VORTEX IMPELLER

GENERAL FEATURES

		Materials/Constr.design
Vortex impeller		Cast iron EN GJL200
External casing		Cast iron EN GJL200
Pump body		Cast iron EN GJL200
Cover		Cast iron EN GJL200
Mechanical seal		Silicon carbide (SiC/SiC)
Motor shaft		Stainless steel AISI416
Power cable	Type	10 m H07RN-F type
	Single-phase	4G1,5mm ² , capacitor box and SCHUKO plug (CEE 7/VII)
	Three-phase	4G1,5mm ²
		Motor
Constr.design		asynchronous squirrel cage-type oil filled
Type		4 poles; 50 Hz
Insulation class		F
Protection degree		IP68
Voltage	Single-phase	230V ±6% built-in overheating protection (up to 1,1 kW), float switch as optional capacitor box and SCHUKO plug (CEE 7/VII)
	Three-phase	230V ±10%, 400V ±10%
		Limits of use
Maximum liquid temperature		+40 °C
pH of pumped liquid		6 - 10
Liquid density		1,0 kg/dm ³
Maximum immersion depth:		5 m
Min. immersion depth for continuous service		
50FWC-V-54-0,75M/T		353 mm
50FWC-V-54-1,1M/T		380 mm
Free passage	50FWC-V-54-0,75M/T	40 mm
	50FWC-V-54-1,1M/T	50 mm
Max. number of starting/hour		20
		Construction options

- 60 Hz version
- Different voltages
- Food-grade white oil

DIMENSIONAL DRAWINGS

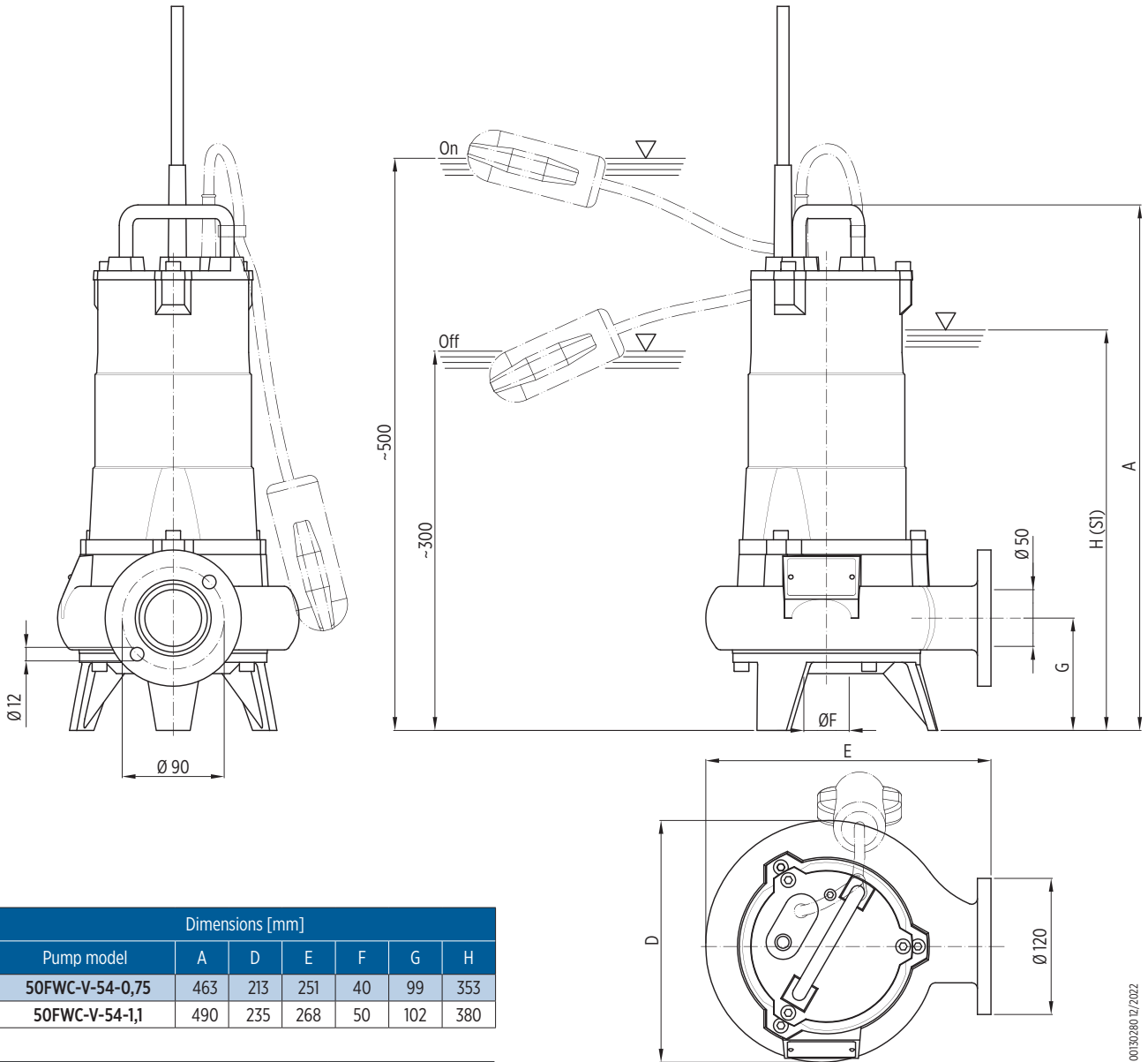

Dimensions [mm]						
Pump model	A	D	E	F	G	H
50FWC-V-54-0,75	463	213	251	40	99	353
50FWC-V-54-1,1	490	235	268	50	102	380

Packaging		
Pump model	Dimensions [mm]	Weight [kg]
50FWC-V-54-0,75	290x245x585	30
50FWC-V-54-1,1	300x260x585	34

00130280.12/2022

TECHNICAL DATA

Pump model	Motor absorbed power P ₁	Rated power P ₂		Voltage	Rated current	Phase	Power cable		float switch	Running capacitor	Delivery port	Weight [kg]
	[kW]	[kW]	[HP]	[V]	[A]		length [m]	Type		[µf]		
50FWC-V-54-0,75M	1,2	0,75	1	230	5	1 ~	10	4G1,5	-	14	G2 (Ø50)	29
50FWC-V-54-0,75M-G	1,2	0,75	1	230	5	1 ~	10	4G1,5	•	14	G2 (Ø50)	29
50FWC-V-54-0,75T	1,2	0,75	1	400	1,9	3 ~	10	4G1,5	-	-	G2 (Ø50)	29
50FWC-V-54-0,75T-G	1,2	0,75	1	400	1,9	3 ~	10	4G1,5	•	-	G2 (Ø50)	29
50FWC-V-54-1,1M	1,5	1,1	1,5	230	7,7	1 ~	10	4G1,5	-	20	G2 (Ø50)	33
50FWC-V-54-1,1M-G	1,5	1,1	1,5	230	7,7	1 ~	10	4G1,5	•	20	G2 (Ø50)	33
50FWC-V-54-1,1T	1,5	1,1	1,5	400	2,8	3 ~	10	4G1,5	-	-	G2 (Ø50)	33
50FWC-V-54-1,1T-G	1,5	1,1	1,5	400	2,8	3 ~	10	4G1,5	•	-	G2 (Ø50)	33

"-" = not available

• = available

HYDRAULIC PERFORMANCE AT 50 HZ

Pump model	Phase	Q = Delivery											
		l/sec 0	1	2	3	4	5	6	7	8	9	10	11
		m ³ /h 0	3,6	7,2	10,8	14,4	18	21,6	25,2	28,8	32,4	36	39,6
		US gpm 0	15,8	31,7	47,5	63,4	79,2	92,1	110,9	126,8	142,6	158,5	174,3
50FWC-V-54-0,75	1 ~	6,4	6,2	5,8	5,3	4,6	3,8	2,8	1,8				
	3 ~	6,4	6,2	5,8	5,3	4,6	3,8	2,8	1,8				
50FWC-V-54-1,1	1 ~	7,4	7	6,6	6,2	5,8	5,4	4,9	4,4	3,9	3,3	2,5	1,6
	3 ~	7,4	7	6,6	6,2	5,8	5,4	4,9	4,4	3,9	3,3	2,5	1,6

HYDRAULIC PERFORMANCE AT 50 HZ

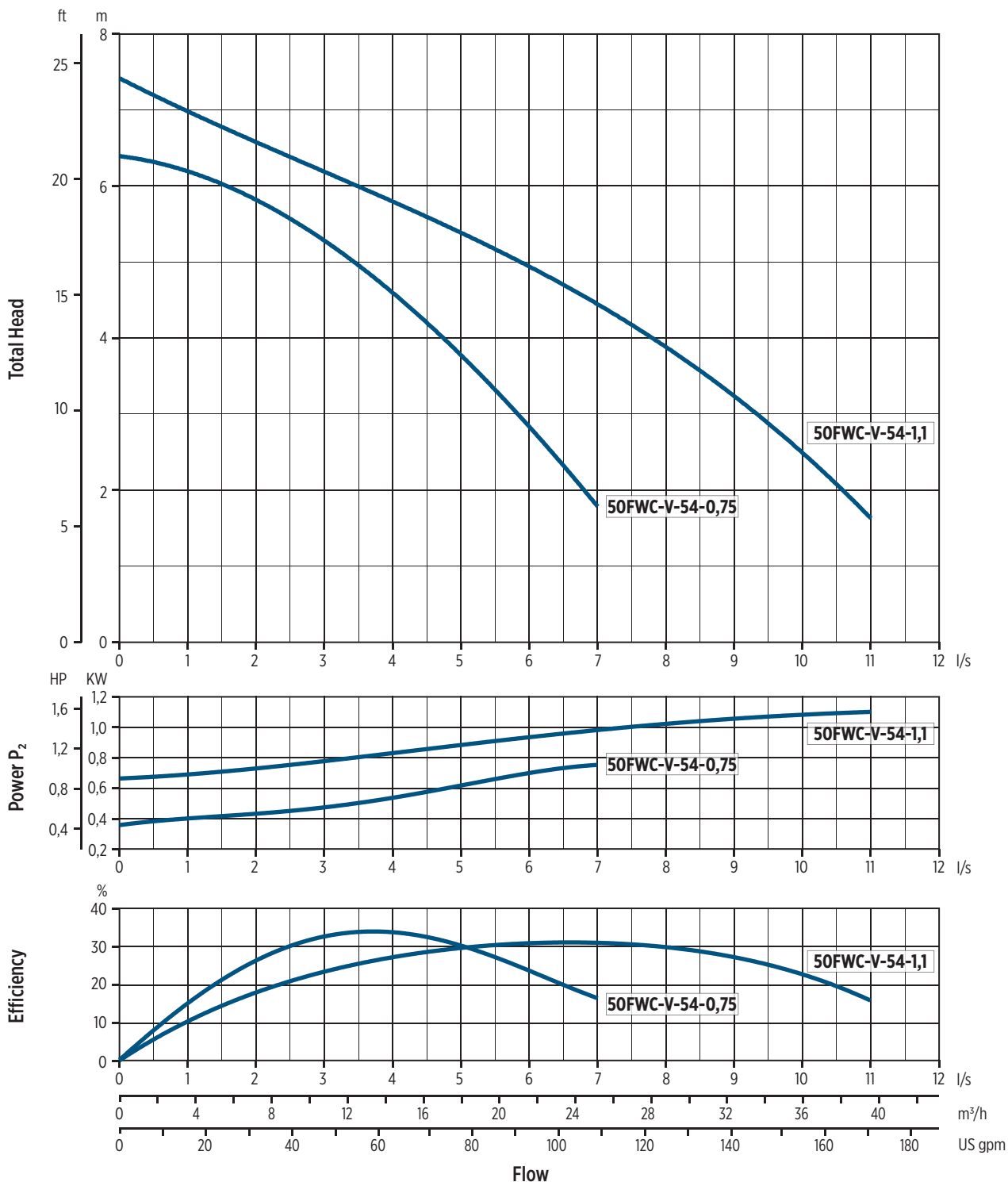

0070096 05/2023

INSTALLATION

INSTALLATION INSTRUCTIONS

PERMANENT INSTALLATION WITH COUPLING SYSTEM

It is the recommended installation for the permanent pumping station. The electric pump is guided by two pipes and it is connected automatically to the coupling system. The quick connection ensures that the pump can be easily removed and re-installed.

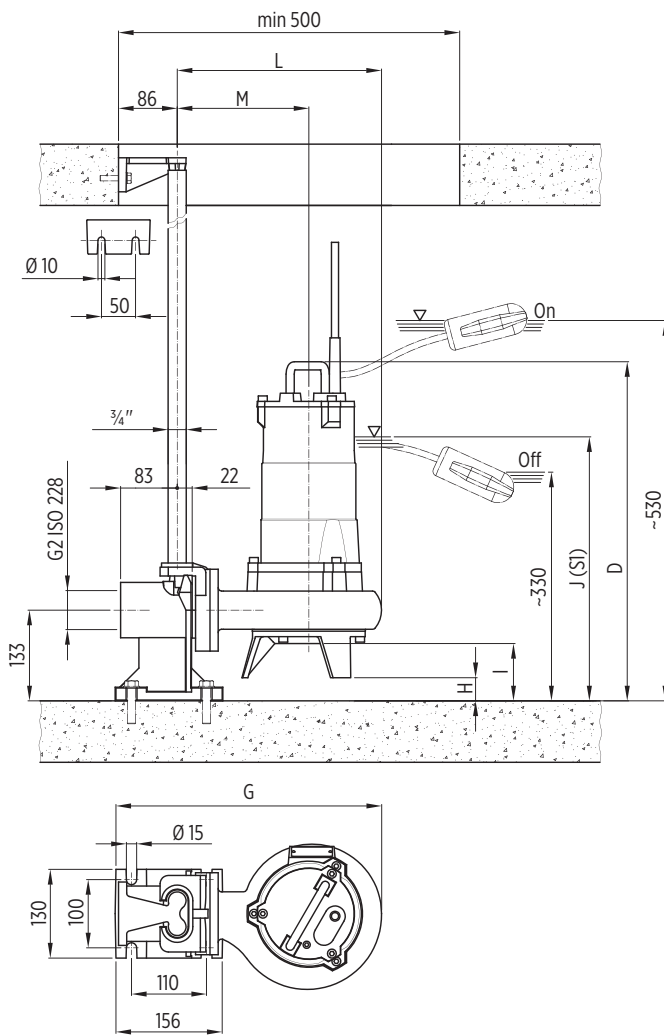

TRANSPORTABLE INSTALLATION

Transportable as emergency pump with connection to the hose and for free installation in the well.

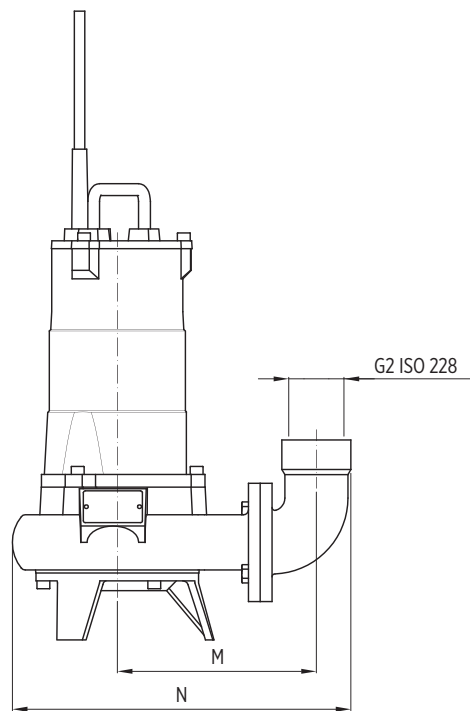

001302860 12/2022

Installation Dimensions [mm]

Pump model	D	G	H	I	J	K	L	M	N
50FWC-V-54-0,75	497	390	34	84	387	193	300	202	344
50FWC-V-54-1,1	521	407	31	81	414	200	316	209	360

65FWC V SERIES 50 HZ

FEATURES & BENEFITS

APPLICATIONS



Domestic / industrial grey water



Extraction of water from ponds, streams or pits and for rainwater collection



Wastewater



MARKETS



RESIDENTIAL



COMMERCIAL



INDUSTRY



AGRICULTURE

CAST IRON SUBMERSIBLE WASTEWATER LIFT PUMPS

Submersible electric pumps particularly suitable for pumping industrial sewage, screened waste water and mud in the pumping stations. They can be used also to lift clear and dirty water and rain water.

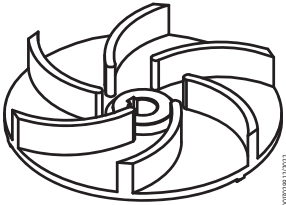

00008 V2022

VORTEX IMPELLER

GENERAL FEATURES

		Materials/Constr.design
Vortex impeller		Cast iron EN GJL200
External casing		Cast iron EN GJL200
Pump body		Cast iron EN GJL200
Cover		Cast iron EN GJL200
Mechanical seal	motor side	Seal ring
	pump side	Silicon carbide (SiC/SiC)
Motor shaft		Stainless steel AISI420
Power cable		10 m H07RN-F type, 4G1,5mm ²
		Motor
Constr.design		asynchronous squirrel cage-type oil filled
Type		2 poles; 50 Hz
Insulation class		F
Protection degree		IP68
Voltage	Three-phase	230V ±10%, 400V ±10%
		Limits of use
Maximum liquid temperature		+40 °C
pH of pumped liquid		6 - 10
Liquid density		1,0 kg/dm ³
Maximum immersion depth:		5 m
Min. immersion depth for continuous service		464 mm
Free passage		65 mm
Max. number of starting/hour		20
		Construction options

- 60 Hz version
- Different voltages
- Food-grade white oil

DIMENSIONAL DRAWINGS

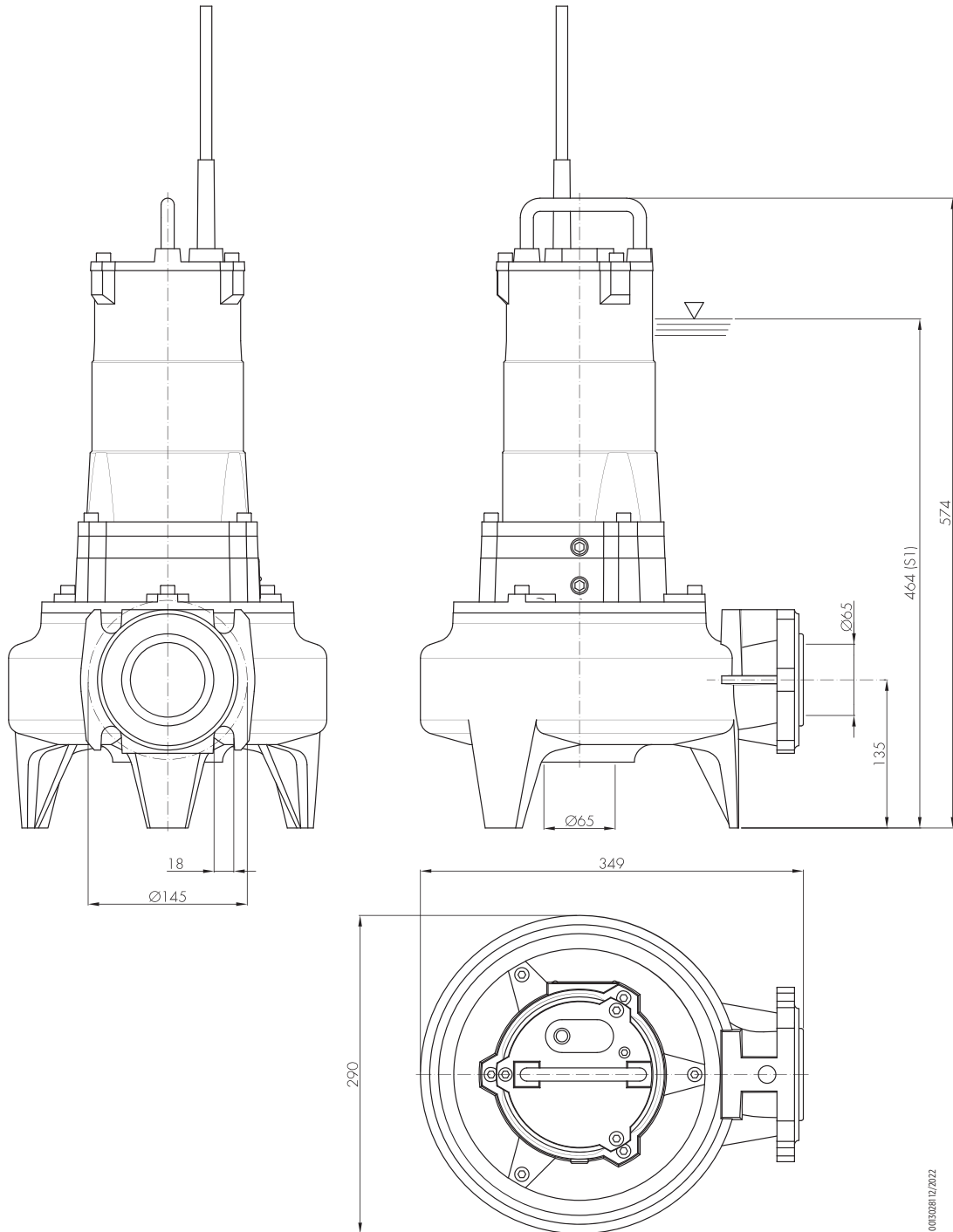

005028112/2022

Packaging

Pump model	Dimensions [mm]	Weight [kg]
65FWC-V-52-2,2	420x325x675	50

TECHNICAL DATA

Pump model	Motor absorbed power P ₁	Rated power P ₂		Voltage	Rated current	Phase	Power cable		float switch	Running capacitor	Delivery port	Weight [kg]
	[kW]	[kW]	[HP]	[V]	[A]		length [m]	Type		[μf]		
65FWC-V-52-2,2T	3,2	2,2	3	400	5,2	3 -	10	4G1,5	-	-	DN65	48

“-” = not available
 • = available

HYDRAULIC PERFORMANCE AT 50 HZ

Pump model	Phase	Q = Delivery										
		l/sec 0	4	6	8	9	10	11	12	13	14	15
		m ³ /h 0	14,4	21,6	28,8	32,4	36	39,6	43,2	46,8	50,4	54
		US gpm 0	63,4	92,1	126,8	142,6	158,5	174,3	190,2	206	221,9	237,7
65FWC-V-52-2,2	3 -	16,5	12,5	10,2	9	8	6,8	6	5,3	3,7	2	1,5

HYDRAULIC PERFORMANCE AT 50 HZ

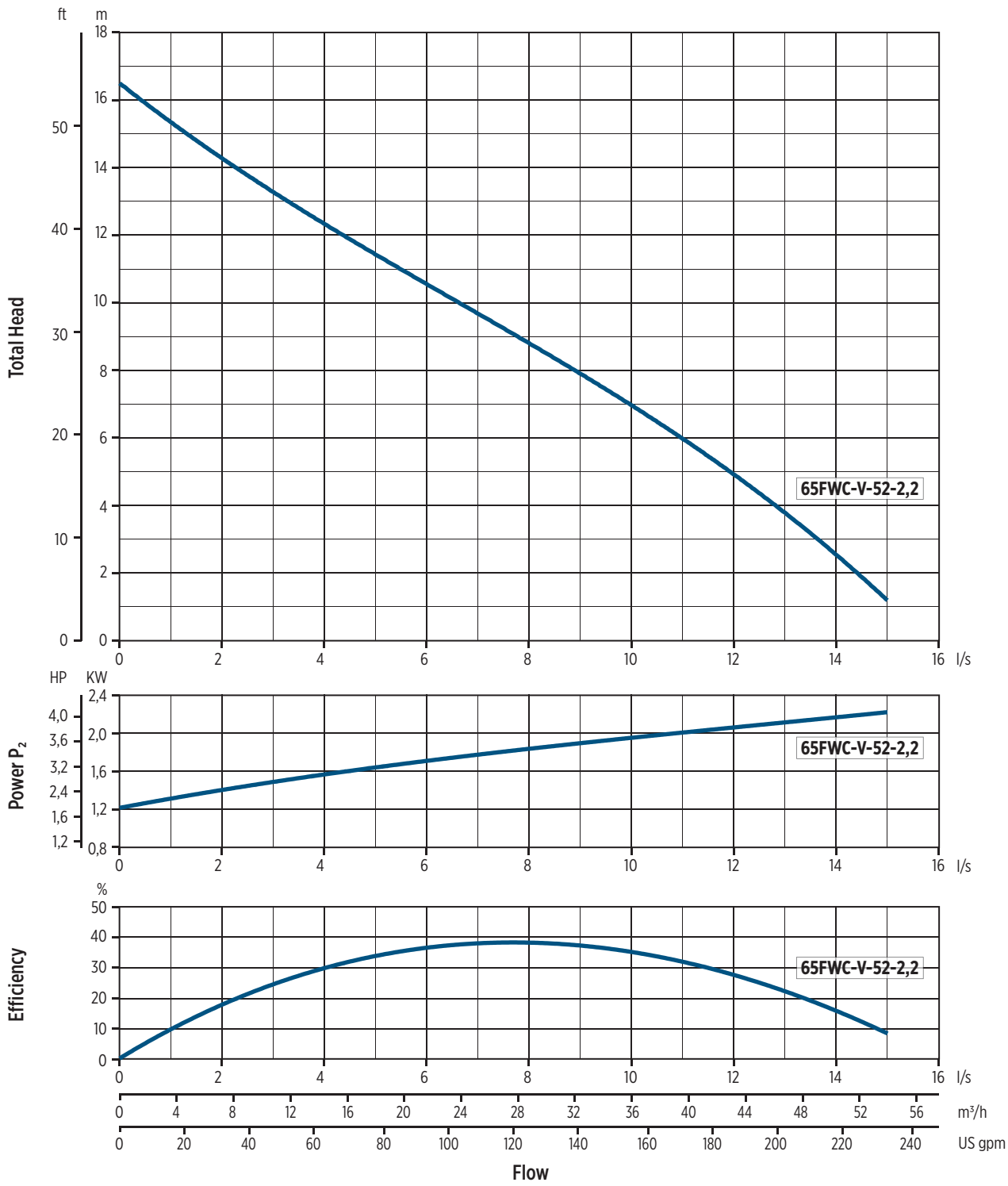

002009712/2022

INSTALLATION

INSTALLATION INSTRUCTIONS

PERMANENT INSTALLATION WITH COUPLING SYSTEM

It is the recommended installation for the permanent pumping station. The electric pump is guided by two pipes and it is connected automatically to the coupling system. The quick connection ensures that the pump can be easily removed and re-installed.

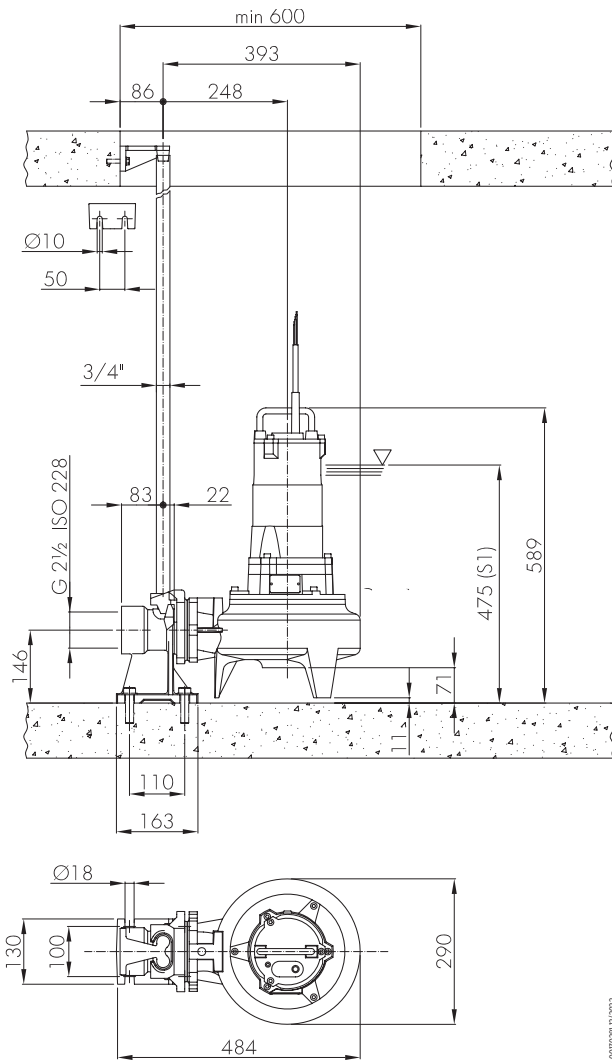

TRANSPORTABLE INSTALLATION

Transportable as emergency pump with connection to the hose and for free installation in the well.

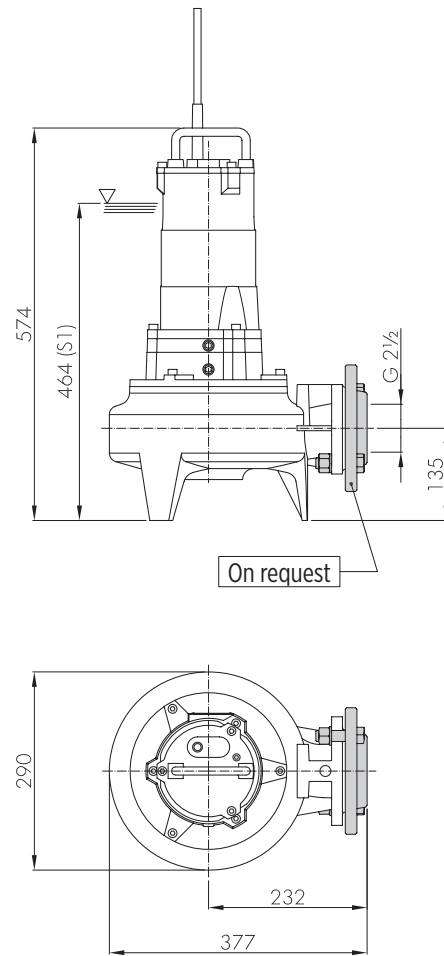

65FWC M SERIES 50 HZ

FEATURES & BENEFITS

APPLICATIONS



Domestic / industrial grey water



Extraction of water from ponds, streams or pits and for rainwater collection



Wastewater



MARKETS



RESIDENTIAL



COMMERCIAL



INDUSTRY



AGRICULTURE

CAST IRON SUBMERSIBLE WASTEWATER LIFT PUMPS

Submersible electric pumps suitable for pumping screened waste water, draining the sewage of blocks of flats and houses and flooded premises in general.

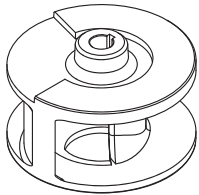

010000101002

SINGLE-CHANNEL IMPELLER

GENERAL FEATURES

		Materials/Constr.design
Single-channel impeller		Cast iron EN GJL200
External casing		Cast iron EN GJL200
Pump body		Cast iron EN GJL200
Cover		Cast iron EN GJL200
Mechanical seal	motor side	Seal ring
	pump side	Silicon carbide (SiC/SiC)
Motor shaft		Stainless steel AISI420
Power cable		10 m H07RN-F type, 4G1,5mm ²
Motor		
Constr.design		asynchronous squirrel cage-type oil filled
Type		2 poles; 50 Hz
Insulation class		F
Protection degree		IP68
Voltage	Three-phase	230V ±10%, 400V ±10%
Limits of use		
Maximum liquid temperature		+40 °C
pH of pumped liquid		6 - 10
Liquid density		1,0 kg/dm ³
Maximum immersion depth:		5 m
Min. immersion depth for continuous service		445 mm
Free passage		50 mm
Max. number of starting/hour		20
Construction options		

- 60 Hz version
- Different voltages
- Food-grade white oil

DIMENSIONAL DRAWINGS

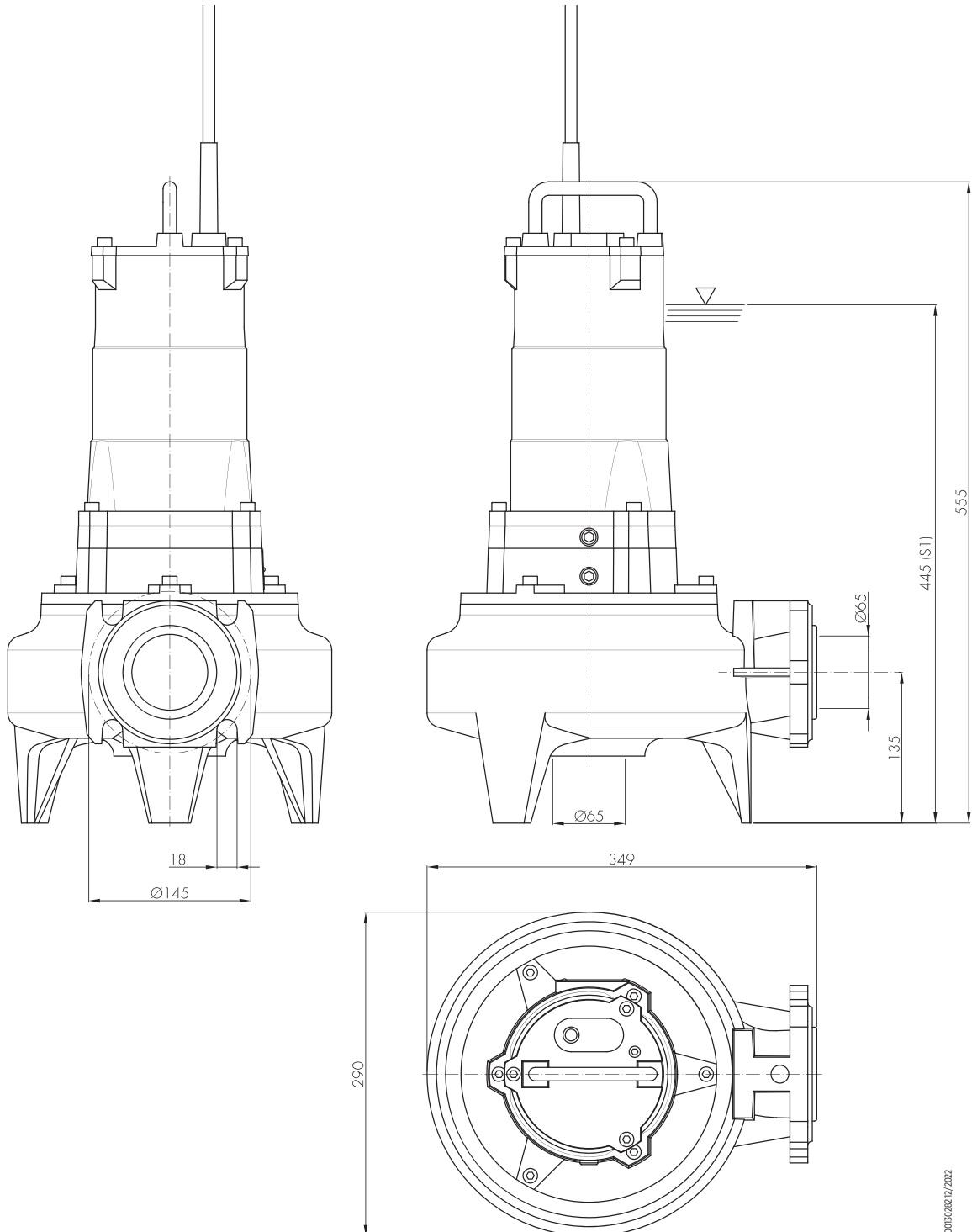

00130282.12/2022

Packaging		
Pump model	Dimensions [mm]	Weight [kg]
65FWC-M-52-1,6T	420x325x675	52
65FWC-M-52-2,2T	420x325x675	52

TECHNICAL DATA

Pump model	Motor absorbed power P ₁	Rated power P ₂		Voltage	Rated current	Phase	Power cable		float switch	Running capacitor	Delivery port	Weight [kg]
	[kW]	[kW]	[HP]	[V]	[A]		length [m]	Type		[μf]		
65FWC-M-52-1,6T	2,5	1,6	2,1	400	4,4	3 -	10	4G1,5	-	-	DN65	50
65FWC-M-52-2,2T	3,2	2,2	3	400	5,2	3 -	10	4G1,5	-	-	DN65	50

"-" = not available
 • = available

HYDRAULIC PERFORMANCE AT 50 HZ

Pump model	Phase	Q = Delivery												
		l/sec 0	4	6	8	9	10	11	12	13	14	15	16	18
		m ³ /h 0	14,4	21,6	28,8	32,4	36	39,6	43,2	46,8	50,4	54	57,6	64,8
		US gpm 0	63,4	92,1	126,8	142,6	158,5	174,3	190,2	206	221,9	237,7	253,6	285,3
		H = Total meters head of water column [m]												
65FWC-M-52-1,6	3 -	18,5	12,5	10,4	8,5	7,7	6,8	5,7	4,9	3,6	2,3	1		
65FWC-M-52-2,2	3 -	24	17,8	15,3	13,2	12	11,3	10,2	9,1	7,9	6,6	5,1	3,6	1

HYDRAULIC PERFORMANCE AT 50 HZ

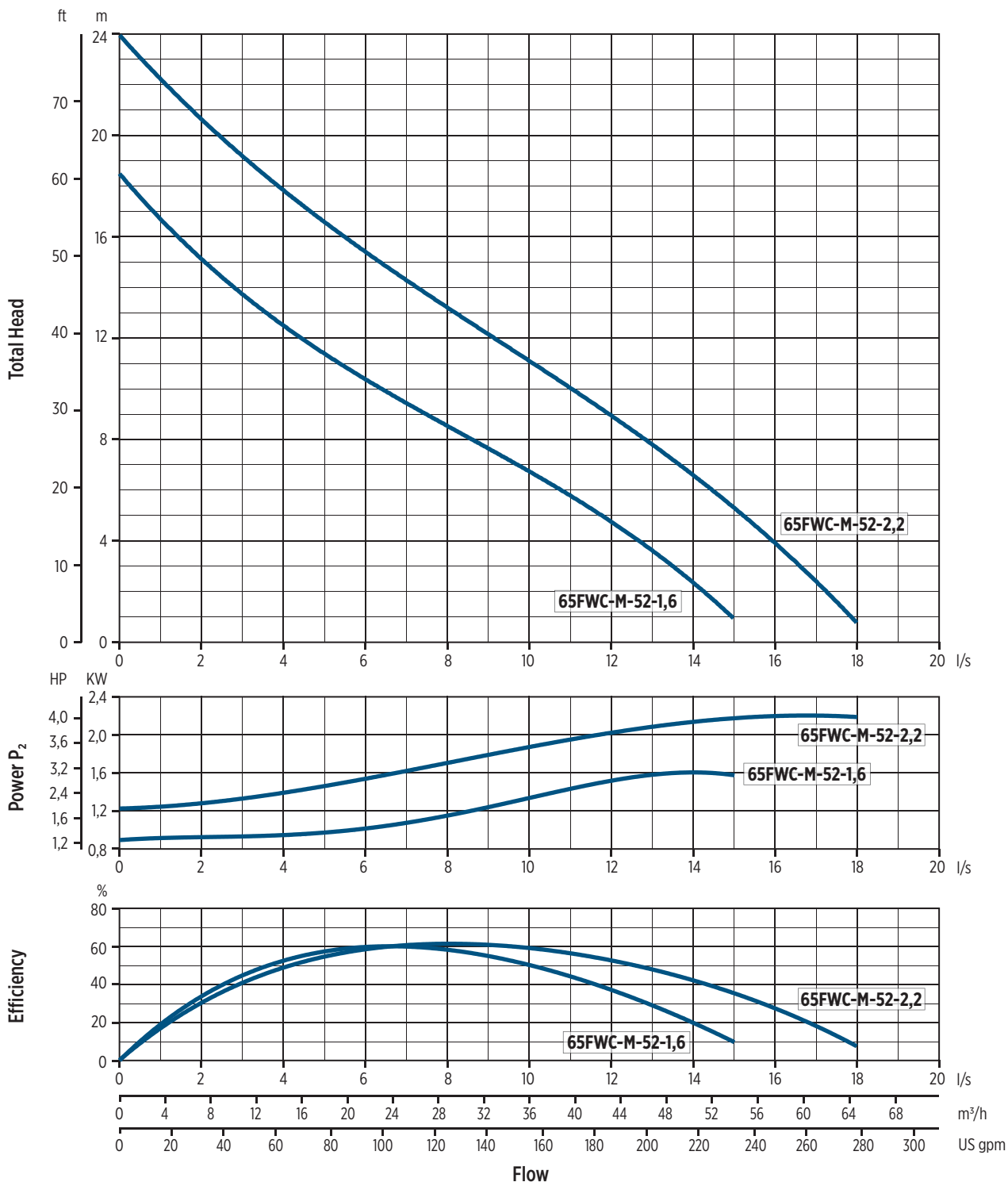

0010098 12/2022

INSTALLATION

INSTALLATION INSTRUCTIONS

PERMANENT INSTALLATION WITH COUPLING SYSTEM

It is the recommended installation for the permanent pumping station. The electric pump is guided by two pipes and it is connected automatically to the coupling system. The quick connection ensures that the pump can be easily removed and re-installed.

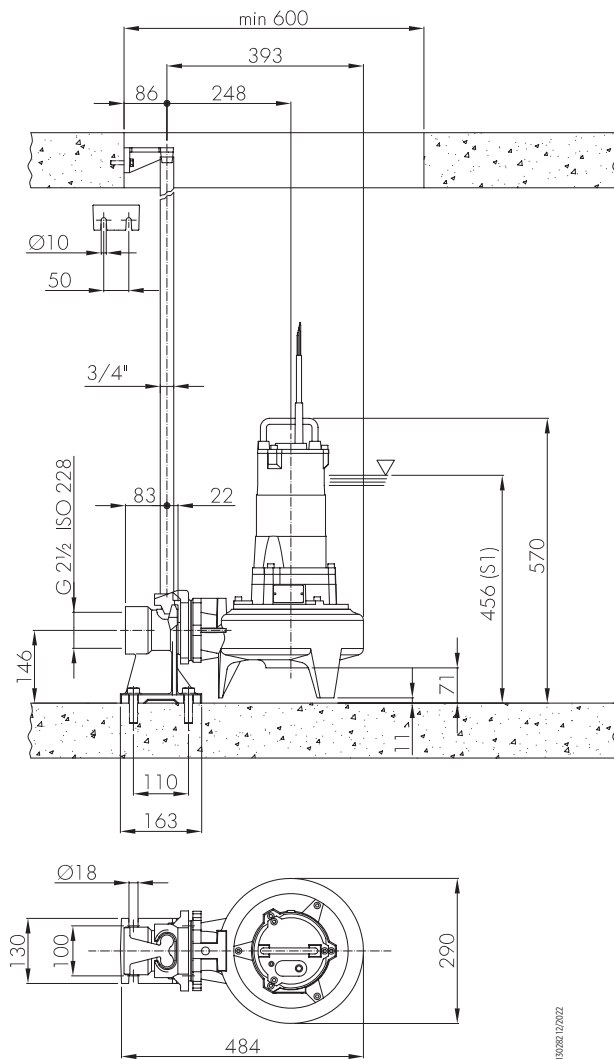

00102062.12/2022

TRANSPORTABLE INSTALLATION

Transportable as emergency pump with connection to the hose and for free installation in the well.

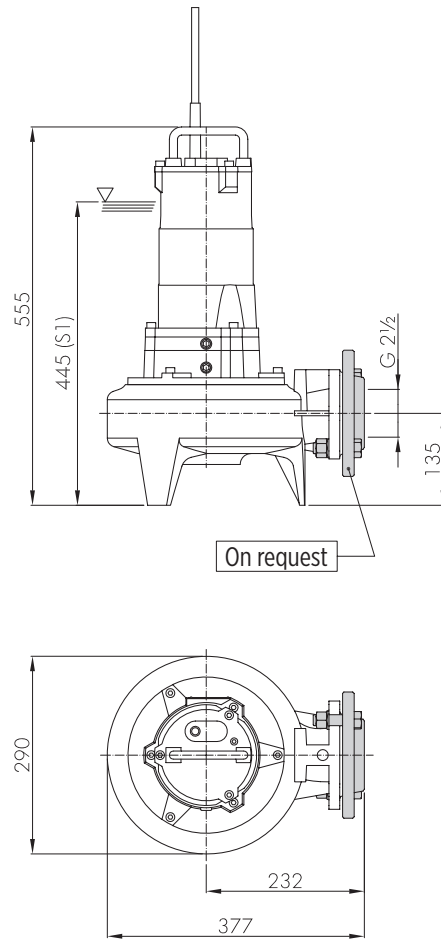

On request

00102062.12/2022

65FWC V4 SERIES 50 HZ

FEATURES & BENEFITS

APPLICATIONS



Domestic / industrial grey water



Extraction of water from ponds, streams or pits and for rainwater collection



Wastewater



MARKETS



RESIDENTIAL



COMMERCIAL



INDUSTRY



AGRICULTURE

CAST IRON SUBMERSIBLE WASTEWATER LIFT PUMPS

Submersible electric pumps particularly suitable for pumping industrial sewage, screened waste water and mud in the pumping stations. They can be used also to lift clear and dirty water and rain water.

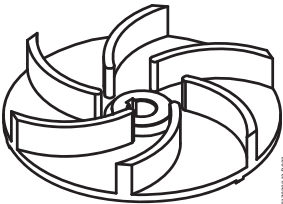

VORTEX IMPELLER

GENERAL FEATURES

		Materials/Constr.design
Vortex impeller		Cast iron EN GJL200
External casing		Cast iron EN GJL200
Pump body		Cast iron EN GJL200
Cover		Cast iron EN GJL200
Mechanical seal		Silicon carbide (SiC/SiC)
Motor shaft		Stainless steel AISI420
Power cable	Type	10 m H07RN-F type
	Single-phase	4G1,5mm ² , capacitor box and SCHUKO plug (CEE 7/VII)
	Three-phase	4G1,5mm ²
		Motor
Constr.design		asynchronous squirrel cage-type oil filled
Type		4 poles; 50 Hz
Insulation class		F
Protection degree		IP68
Voltage	Single-phase	230V ±6% built-in overheating protection capacitor box and SCHUKO plug (CEE 7/VII)
	Three-phase	230V ±10%, 400V ±10%
		Limits of use
Maximum liquid temperature		+40 °C
pH of pumped liquid		6 - 10
Liquid density		1,0 kg/dm ³
Maximum immersion depth:		5 m
Min. immersion depth for continuous service		442 mm
Free passage		60 mm
Max. number of starting/hour		20
		Construction options

- 60 Hz version
- Different voltages
- Food-grade white oil

DIMENSIONAL DRAWINGS

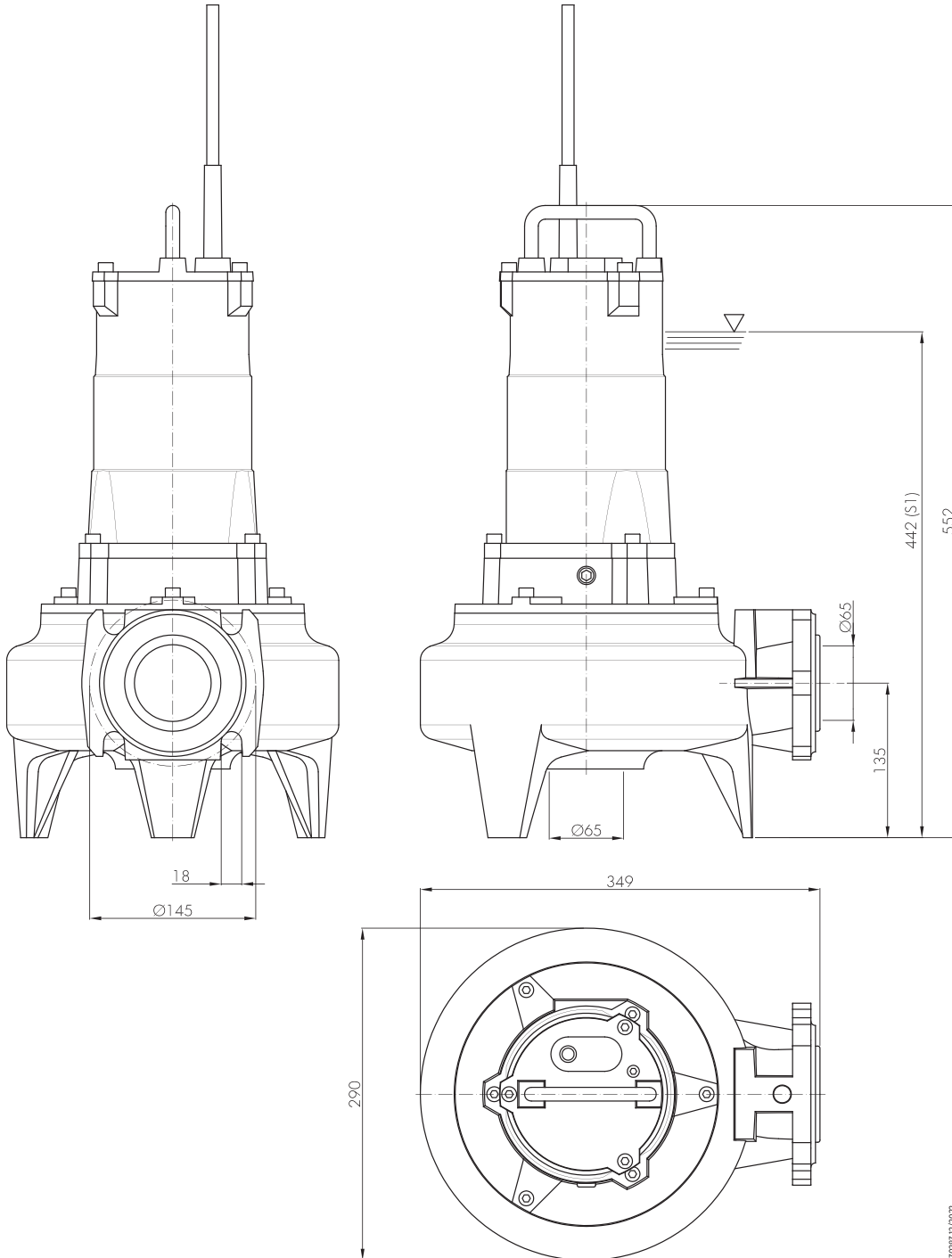

00130283 12/24/2

Packaging		
Pump model	Dimensions [mm]	Weight [kg]
65FWC-V-54-0,75	420x325x675	40
65FWC-V-54-1,1	420x325x675	41
65FWC-V-54-1,6	420x325x675	42

TECHNICAL DATA

Pump model	Motor absorbed power P ₁	Rated power P ₂		Voltage	Rated current	Phase	Power cable		float switch	Running capacitor	Delivery port	Weight [kg]
	[kW]	[kW]	[HP]	[V]	[A]		length [m]	Type		[μf]		
65FWC-V-54-0,75M	1	0,75	1	230	5	1 ~	10	4G1,5	-	14	DN65	38
65FWC-V-54-0,75M-G	1	0,75	1	230	5	1 ~	10	4G1,5	•	14	DN65	38
65FWC-V-54-0,75T	1	0,75	1	400	1,9	3 ~	10	4G1,5	-	-	DN65	38
65FWC-V-54-0,75T-G	1	0,75	1	400	1,9	3 ~	10	4G1,5	•	-	DN65	38
65FWC-V-54-1,1M	1,5	1,1	1,5	230	7	1 ~	10	4G1,5	-	20	DN65	39
65FWC-V-54-1,1M-G	1,5	1,1	1,5	230	7	1 ~	10	4G1,5	•	20	DN65	39
65FWC-V-54-1,1T	1,5	1,1	1,5	400	2,8	3 ~	10	4G1,5	-	-	DN65	39
65FWC-V-54-1,1T-G	1,5	1,1	1,5	400	2,8	3 ~	10	4G1,5	•	-	DN65	39
65FWC-V-54-1,6T	2,5	1,6	2,1	400	4,4	3 ~	10	4G1,5	-	-	DN65	40

"-" = not available

• = available

HYDRAULIC PERFORMANCE AT 50 HZ

Pump model	Phase	Q = Delivery										
		l/sec 0	4	6	8	9	10	11	12	13	14	15
		m ³ /h 0	14,4	21,6	28,8	32,4	36	39,6	43,2	46,8	50,4	54
		US gpm 0	63,4	92,1	126,8	142,6	158,5	174,3	190,2	206	221,9	237,7
H = Total meters head of water column [m]												
65FWC-V-54-0,75	1 ~	6	4,7	3,8	3	2						
	3 ~	6	4,7	3,8	3	2						
65FWC-V-54-1,1	1 ~	8,2	7	6,1	5	4,3	3,7	3	2,2	1,2		
	3 ~	8,2	7	6,1	5	4,3	3,7	3	2,2	1,2		
65FWC-V-54-1,6	3 ~	11	9,5	8,5	7,2	6,6	6,1	5,9	5,4	4,9	4	2,8

HYDRAULIC PERFORMANCE AT 50 HZ

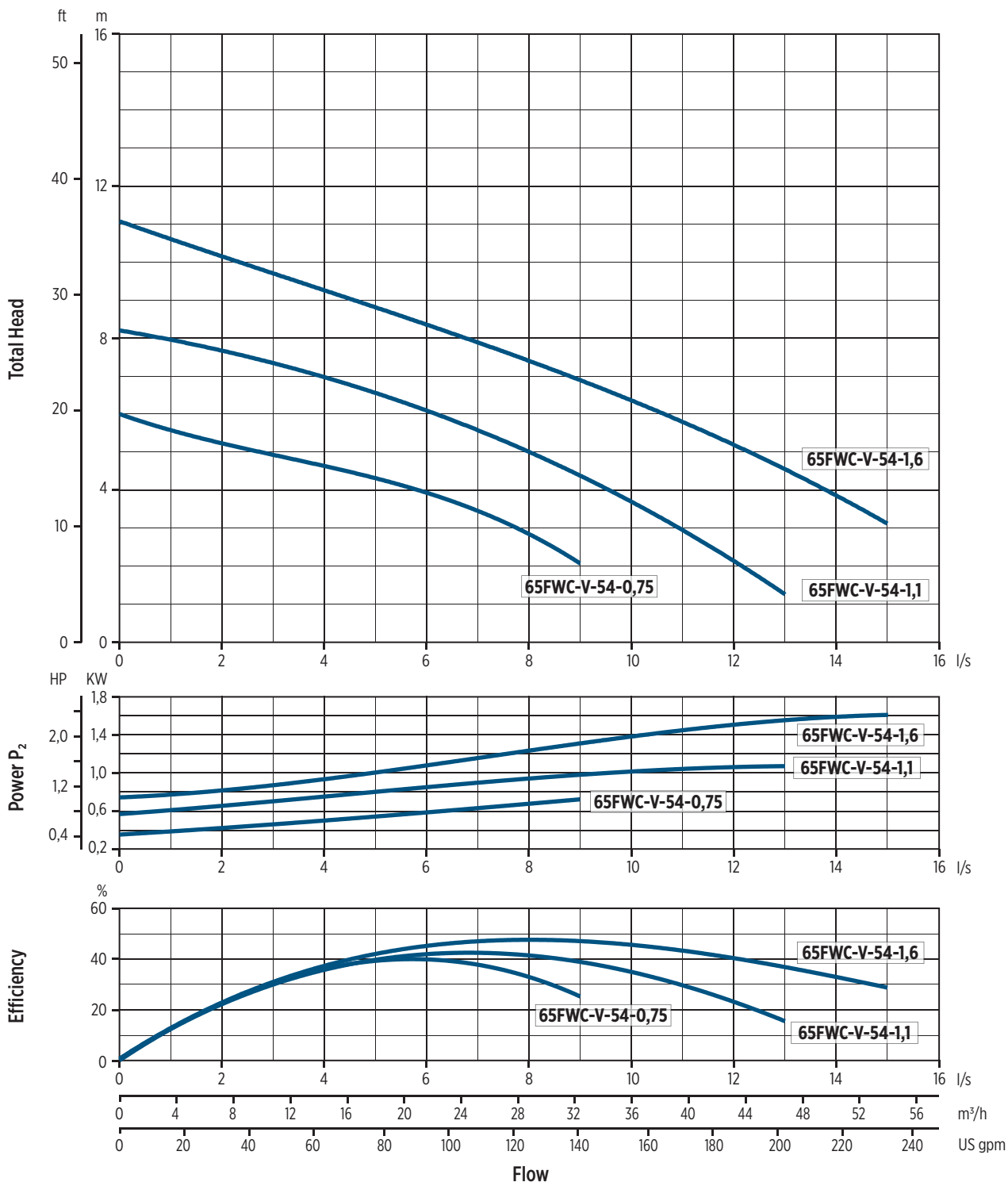

0020099.12/2022

INSTALLATION

INSTALLATION INSTRUCTIONS

PERMANENT INSTALLATION WITH COUPLING SYSTEM

It is the recommended installation for the permanent pumping station. The electric pump is guided by two pipes and it is connected automatically to the coupling system. The quick connection ensures that the pump can be easily removed and re-installed.

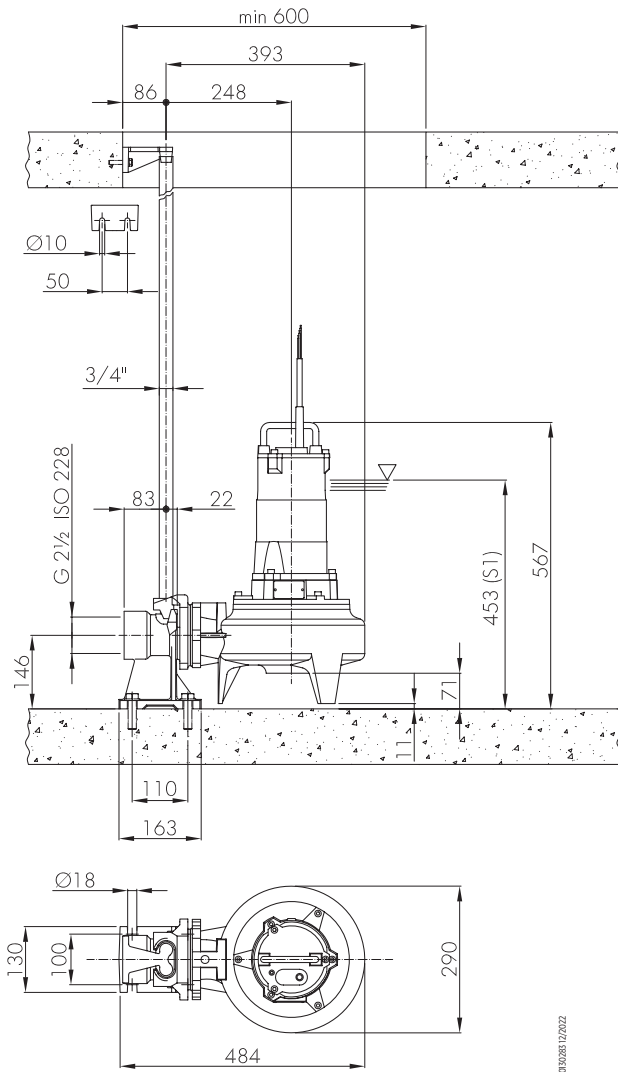

00130285 12/2022

TRANSPORTABLE INSTALLATION

Transportable as emergency pump with connection to the hose and for free installation in the well.

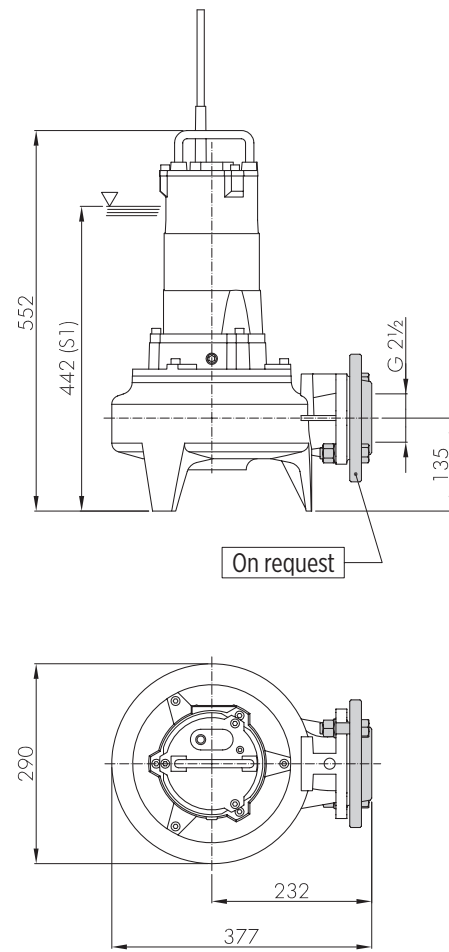

00130285 12/2022

80FWC M4 SERIES 50 HZ

FEATURES & BENEFITS

APPLICATIONS



Domestic / industrial grey water



Extraction of water from ponds, streams or pits and for rainwater collection



Wastewater



MARKETS



CAST IRON SUBMERSIBLE WASTEWATER LIFT PUMPS

Submersible electric pumps particularly suitable for pumping industrial sewage, screened waste water and mud in the pumping stations. They can be used also to lift clear and dirty water and rain water.

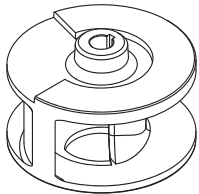

00000011/2022

SINGLE-CHANNEL IMPELLER

GENERAL FEATURES

		Materials/Constr.design
Single-channel impeller		Cast iron EN GJS400
External casing		Cast iron EN GJL250
Pump body		Cast iron EN GJL250
Cover		Cast iron EN GJL250
Mechanical seal	motor side	Graphite/Alumina
	pump side	Silicon carbide (SiC/SiC)
Motor shaft		Stainless steel AISI420
Power cable	Type	10 m SIRN8-F type
	80FWC-M-54-2,2T, 80FWC-M-54-3,1T	4G1,5+3x1mm ²
	80FWC-M-54-5,5T	4G2,5+3x1mm ²
		Motor
Constr.design		asynchronous squirrel cage-type in dry chamber
Type		4 poles; 50 Hz
Insulation class		F
Protection degree		IP68
Voltage	Three-phase	400V ±10%
Probe		Thermal in the winding
		Conductivity in the oil chamber
		Limits of use
Maximum liquid temperature		+40 °C
pH of pumped liquid		6 - 10
Liquid density		1,0 kg/dm ³
Maximum immersion depth:		5 m
Min. immersion depth for continuous service		517 mm
Free passage		80 mm
Max. number of starting/hour		20
		Construction options

- 60 Hz version
- Different voltages

DIMENSIONAL DRAWINGS

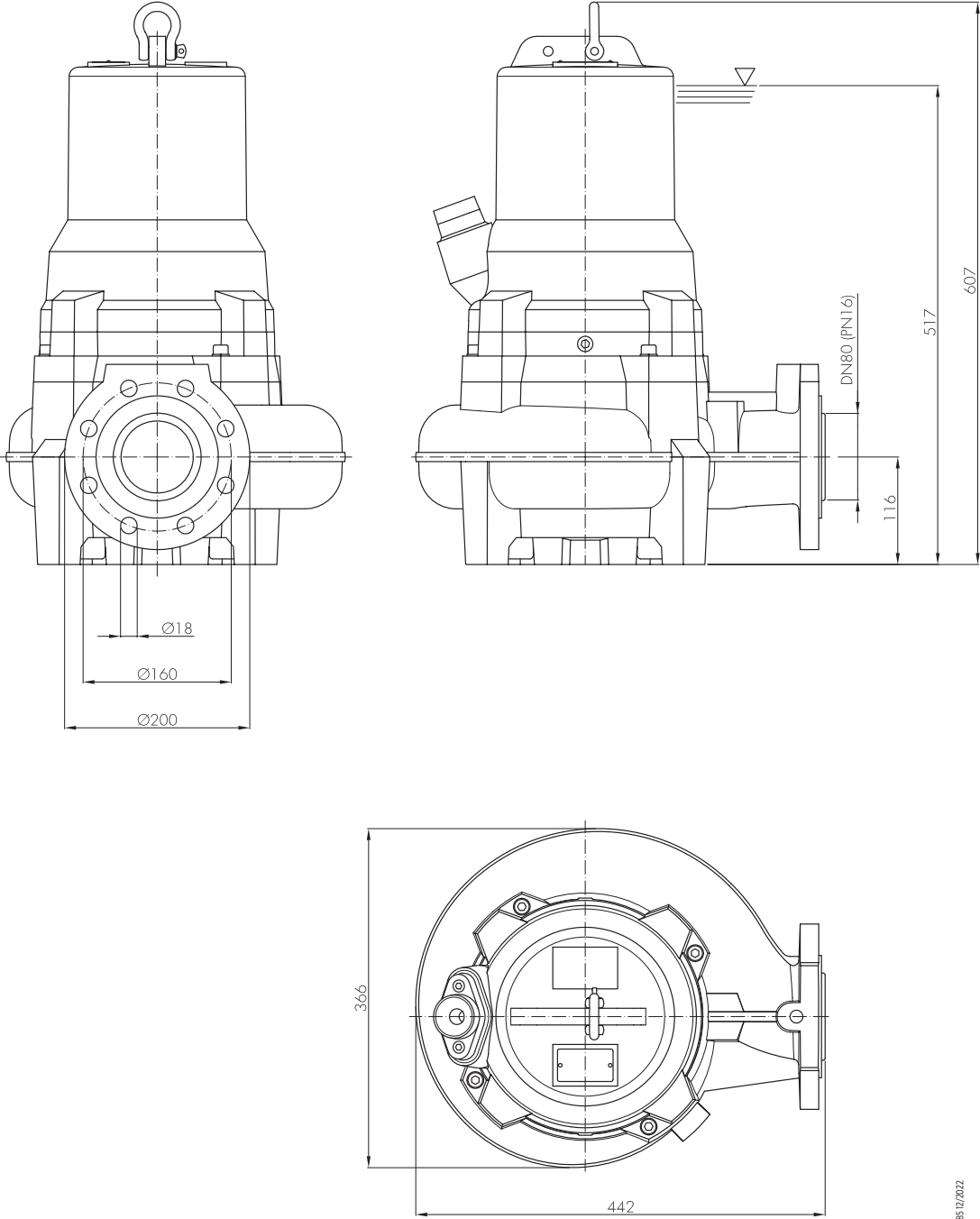

00180285 11/2012

Packaging		
Pump model	Dimensions [mm]	Weight [kg]
80FWC-M-54-2,2T	475x370x985	99
80FWC-M-54-3,1T	475x370x985	102
80FWC-M-54-5,5T	475x370x985	114

TECHNICAL DATA

Pump model	Motor absorbed power P ₁	Rated power P ₂		Voltage	Rated current	Phase	Power cable		float switch	Delivery port	Weight [kg]
	[kW]	[kW]	[HP]	[V]	[A]		length [m]	Type			
80FWC-M-54-2,2T	2,8	2,2	3	400	5,4	3 -	10	4G1,5+3x1	-	DN80	96
80FWC-M-54-3,1T	3,9	3,1	4,2	400	7,5	3 -	10	4G1,5+3x1	-	DN80	99
80FWC-M-54-5,5T	6,6	5,5	7,5	400	11,7	3 -	10	4G2,5+3x1	-	DN80	111

"-" = not available

• = available

HYDRAULIC PERFORMANCE AT 50 HZ

Pump model	Phase	Q = Delivery												
		l/sec 0	6	10	15	20	25	30	35	38	40	42,8	45	47
		m ³ /h 0	21,6	36	54	72	90	108	126	136,8	144	154,1	162	169,2
		US gpm 0	92,1	158,5	237,7	317	396,2	475,5	554,8	602,3	634	678,4	713,3	745
		H = Total meters head of water column [m]												
80FWC-M-54-2,2T	3 -	10,8	8,8	7,6	6,4	5,3	3,7	2,4	2					
80FWC-M-54-3,1T	3 -	15,6	12,1	10,8	9,6	8,4	7,1	5,5	5,2	3,7	2			
80FWC-M-54-5,5T	3 -	19,8	16,6	15,1	13,6	12,4	11	9,6	9,2	7,9	6,6	5,2	3	2

HYDRAULIC PERFORMANCE AT 50 HZ

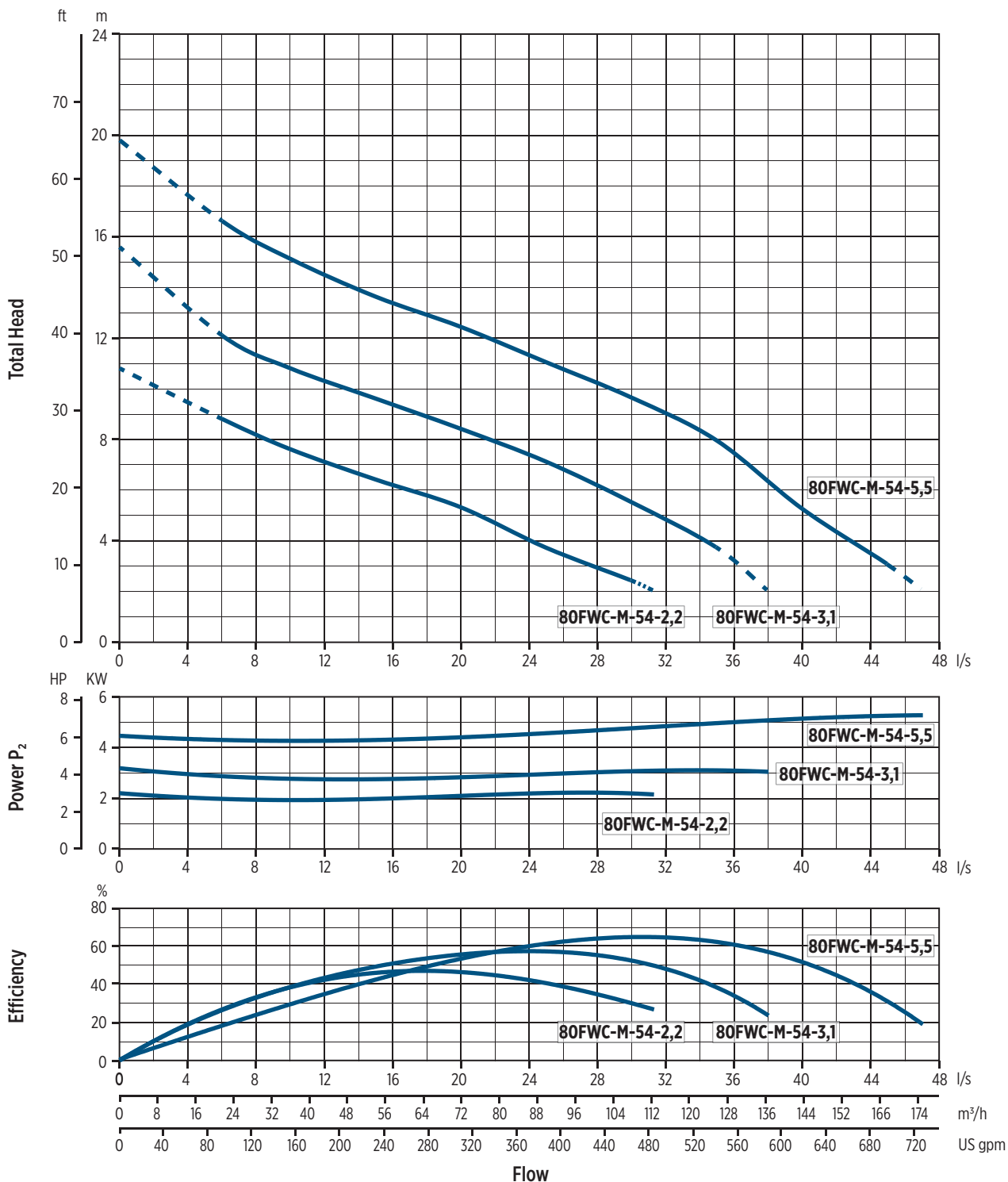

00201012/2022

INSTALLATION

INSTALLATION INSTRUCTIONS

PERMANENT INSTALLATION WITH COUPLING SYSTEM

It is the recommended installation for the permanent pumping station. The electric pump is guided by two pipes and it is connected automatically to the coupling system. The quick connection ensures that the pump can be easily removed and re-installed.

TRANSPORTABLE INSTALLATION

Transportable as emergency pump with connection to the hose and for free installation in the well.

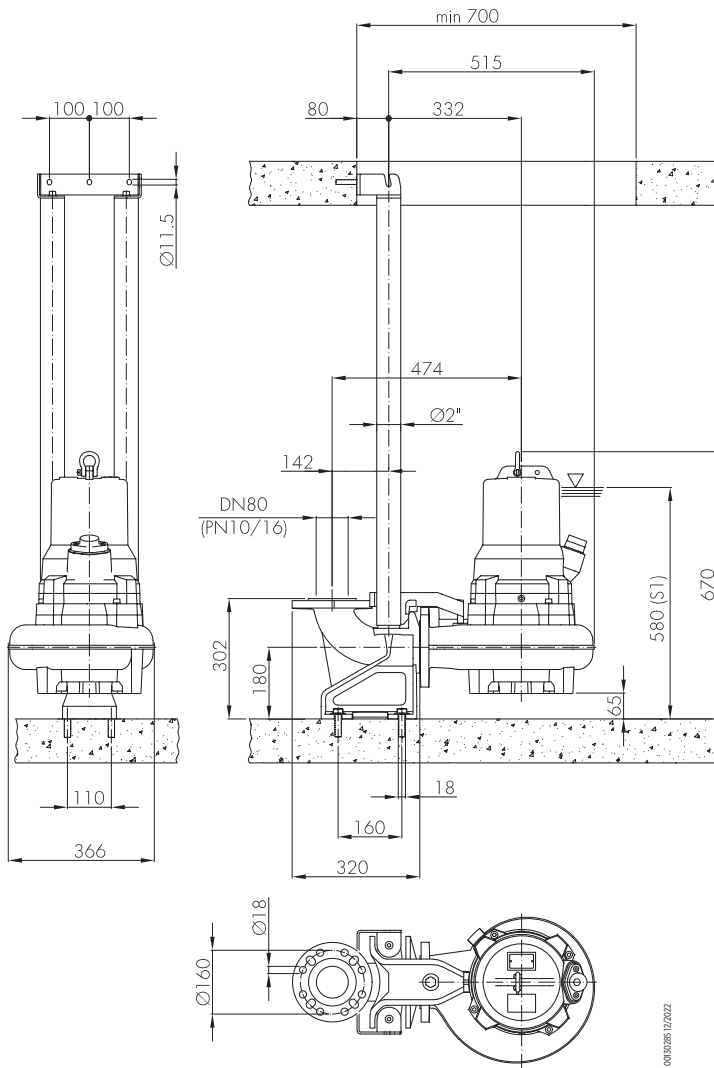

0050265/12/2022

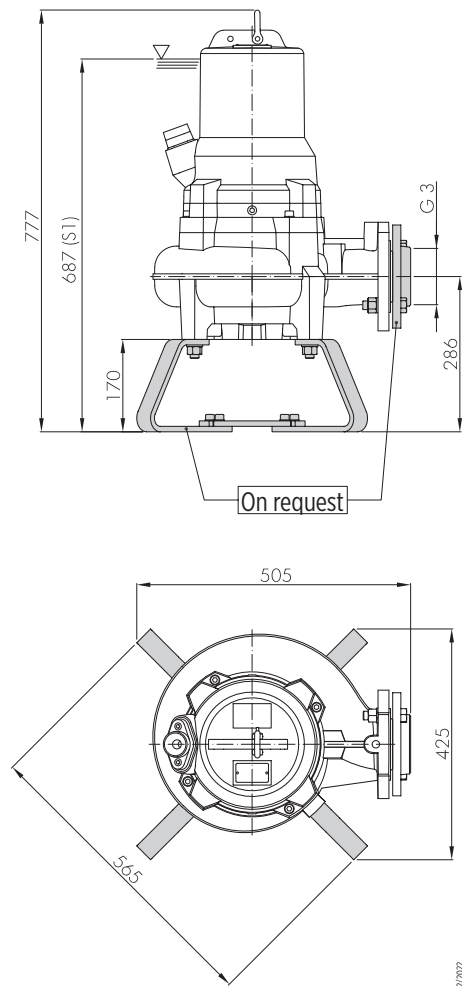

328517/2022

80FWC V4 SERIES 50 HZ

FEATURES & BENEFITS

APPLICATIONS



Domestic / industrial grey water



Extraction of water from ponds, streams or pits and for rainwater collection



Wastewater



For liquids with an high solid content or with filamentous particles



MARKETS



RESIDENTIAL



COMMERCIAL



INDUSTRY



AGRICULTURE

CAST IRON SUBMERSIBLE WASTEWATER LIFT PUMPS

Submersible electric pumps particularly suitable for pumping industrial sewage, screened waste water and mud in the pumping stations. They can be used also to lift clear and dirty water and rain water.

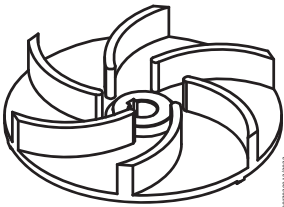

VORTEX IMPELLER

GENERAL FEATURES

Materials/Constr.design		
Vortex impeller	Cast iron EN GJL250	
External casing	Cast iron EN GJL250	
Pump body	Cast iron EN GJL250	
Cover	Cast iron EN GJL250	
Mechanical seal	motor side	Graphite/Alumina
	pump side	Silicon carbide (SiC/SiC)
Motor shaft	Stainless steel AISI420	
Power cable	Type	10 m SIRN8-F type
	80FWC-V-54-1,6T, 80FWC-V-54-2,2T, 80FWC-V-54-3,1T	4G1,5+3x1mm ²
	80FWC-V-54-5,5T	4G2,5+3x1mm ²
Motor		
Constr.design	asynchronous squirrel cage-type in dry chamber	
Type	4 poles; 50 Hz	
Insulation class	F	
Protection degree	IP68	
Voltage	Three-phase	400V ±10%
Probe		Thermal in the winding
		Conductivity in the oil chamber
Limits of use		
Maximum liquid temperature	+40 °C	
pH of pumped liquid	6 - 10	
Liquid density	1,0 kg/dm ³	
Maximum immersion depth:	5 m	
Min. immersion depth for continuous service	500 mm	
Free passage	80 mm	
Max. number of starting/hour	20	
Construction options		

- 60 Hz version
- Different voltages

DIMENSIONAL DRAWINGS

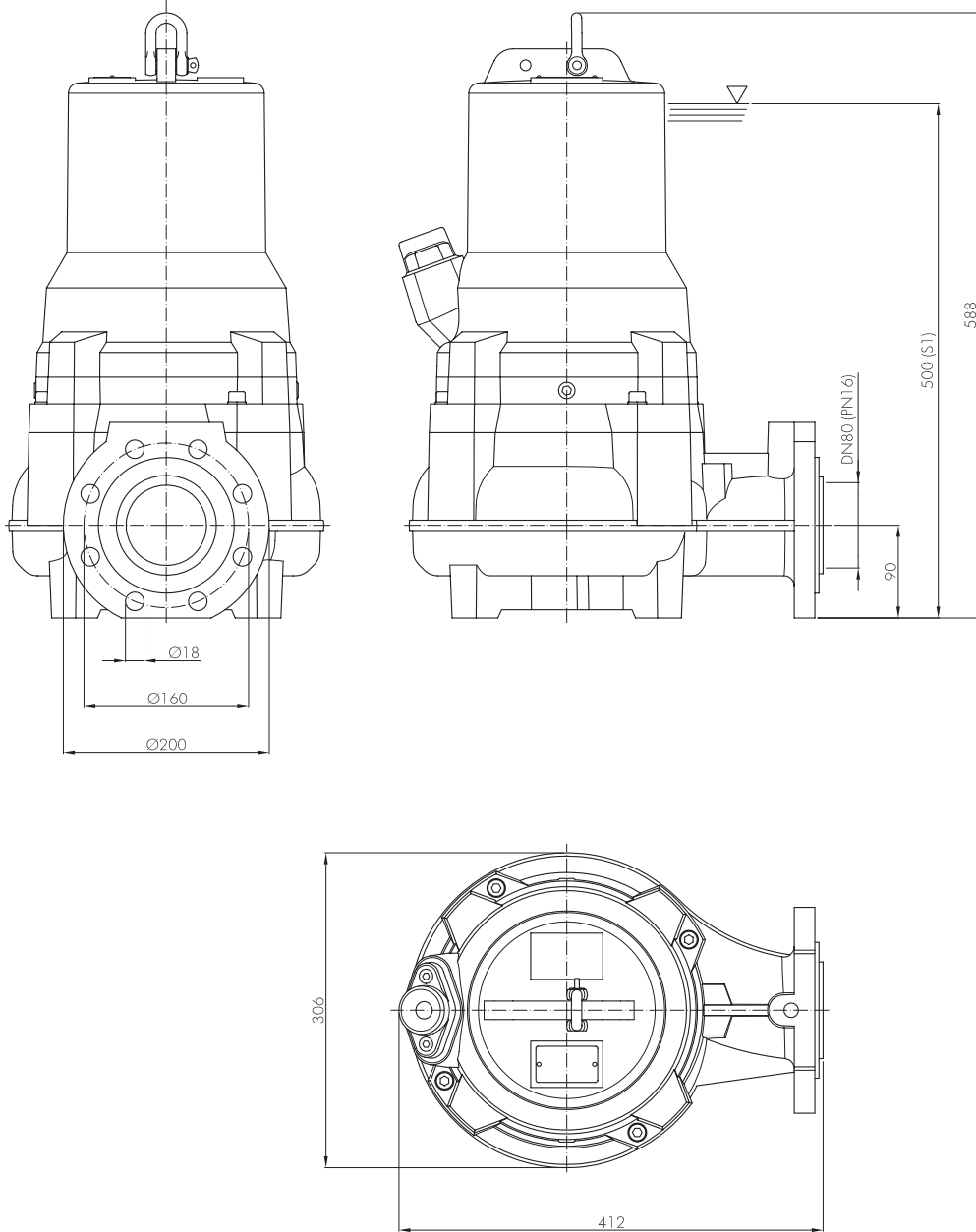

0830284-12/2022

Packaging		
Pump model	Dimensions [mm]	Weight [kg]
80FWC-V-54-1,6T	420x325x675	85
80FWC-V-54-2,2T	420x325x675	87
80FWC-V-54-3,1T	420x325x675	91
80FWC-V-54-5,5T	420x325x675	102

TECHNICAL DATA

Pump model	Motor absorbed power P ₁	Rated power P ₂		Voltage [V]	Rated current [A]	Phase	Power cable		float switch	Delivery port	Weight [kg]
	[kW]	[kW]	[HP]				length [m]	Type			
80FWC-V-54-1,6T	2,3	1,6	2,1	400	4,1	3 -	10	4G1,5+3x1	-	DN80	83
80FWC-V-54-2,2T	2,8	2,2	3	400	5,4	3 -	10	4G1,5+3x1	-	DN80	85
80FWC-V-54-3,1T	3,9	3,1	4,2	400	7,5	3 -	10	4G1,5+3x1	-	DN80	89
80FWC-V-54-5,5T	6,6	5,5	7,5	400	11,7	3 -	10	4G2,5+3x1	-	DN80	100

"-" = not available

• = available

HYDRAULIC PERFORMANCE AT 50 HZ

Pump model	Phase	Q = Delivery															
		l/sec 0	6	8	10	12	14	16	18	20	22	24	26	28	30	32	34
		m ³ /h 0	21,6	28,8	36	43,2	50,4	57,6	64,8	72	79,2	86,4	93,6	100,8	108	115,2	122,4
		US gpm 0	92,1	126,8	158,5	190,2	221,9	253,6	285,3	317	348,7	380,4	412,1	443,8	475,5	507,2	538,9
		H = Total meters head of water column [m]															
80FWC-V-54-1,6T	3 -	9	7,5	6,9	6,2	5,4	4,7		3,8	3	2,2						
80FWC-V-54-2,2T	3 -	10,5	8,8	8,3	7,6	6,9	6,3	5,5	4,7	3,7	2,7						
80FWC-V-54-3,1T	3 -	13	11,1	10,6	9,9	9,3	8,6	7,9	7,1	6,3	5,4	4,4	3,2	2			
80FWC-V-54-5,5T	3 -	16	14,1	13,6	12,8	12,3	11,7	11	10,3	9,5	8,7	7,8	6,9	5,8	4,8	3,5	2,3

HYDRAULIC PERFORMANCE AT 50 HZ

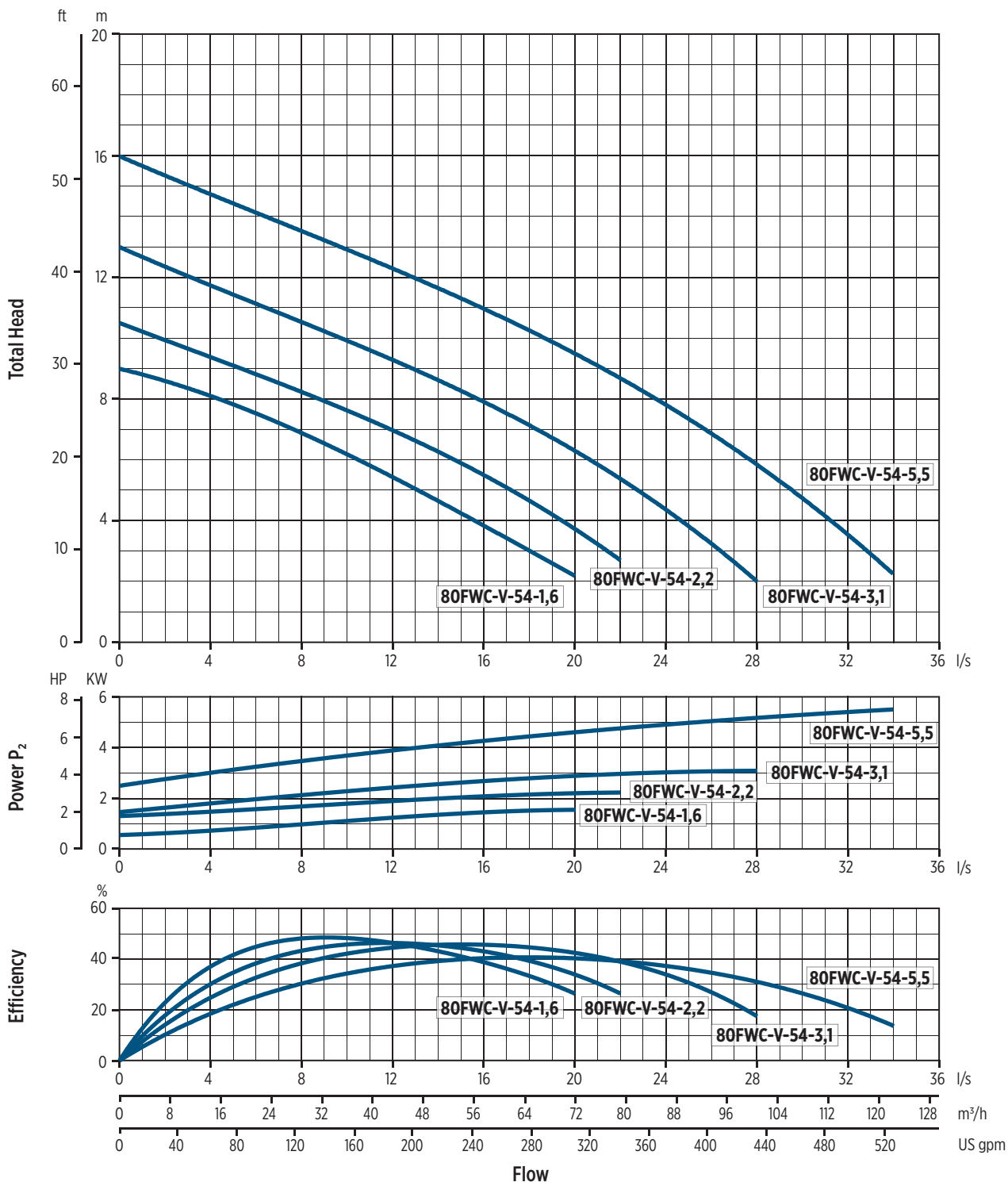

00201003.12/2022

INSTALLATION

INSTALLATION INSTRUCTIONS

PERMANENT INSTALLATION WITH COUPLING SYSTEM

It is the recommended installation for the permanent pumping station. The electric pump is guided by two pipes and it is connected automatically to the coupling system. The quick connection ensures that the pump can be easily removed and re-installed.

TRANSPORTABLE INSTALLATION

Transportable as emergency pump with connection to the hose and for free installation in the well.

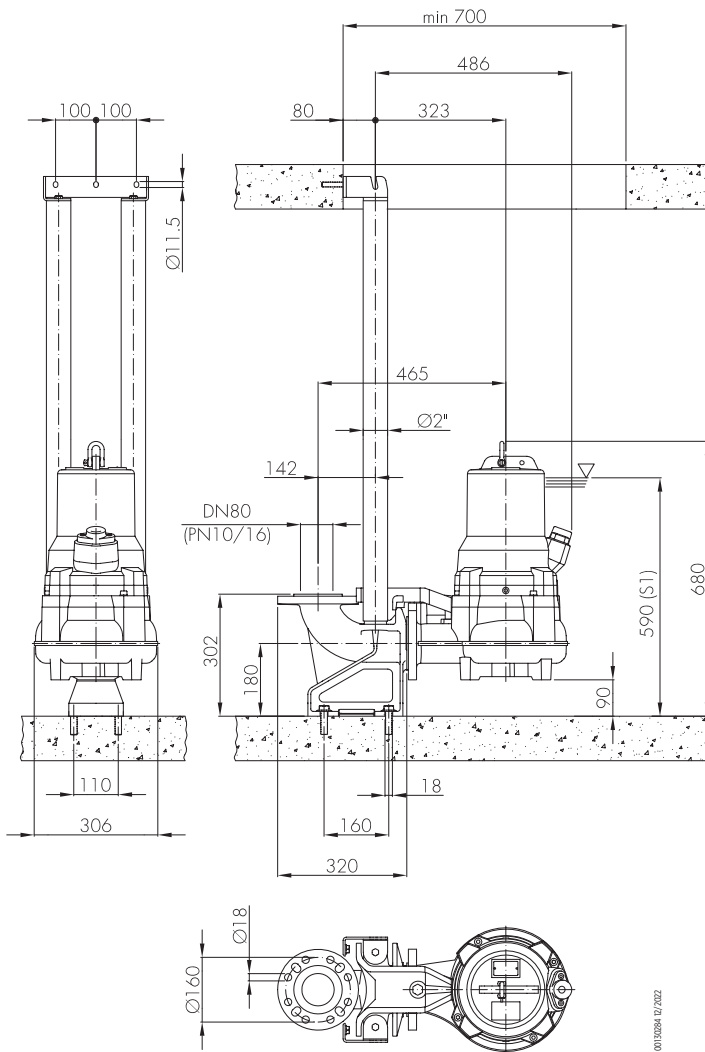

00120284 12/2022

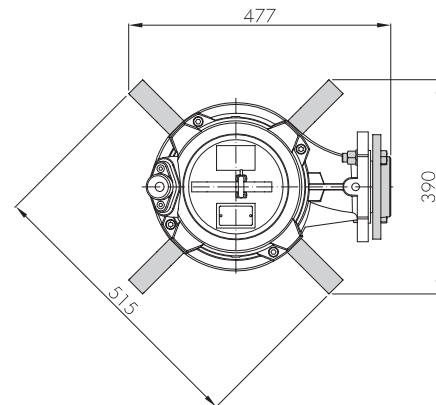
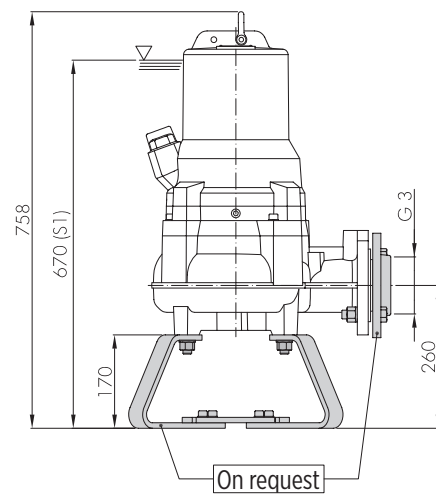

00120284 12/2022

100FWC M4 SERIES 50 HZ

FEATURES & BENEFITS

APPLICATIONS



Domestic / industrial grey water



Extraction of water from ponds, streams or pits and for rainwater collection



Wastewater



MARKETS



RESIDENTIAL



COMMERCIAL

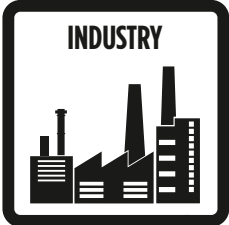

INDUSTRY



AGRICULTURE

CAST IRON SUBMERSIBLE WASTEWATER LIFT PUMPS

Submersible electric pumps particularly suitable for pumping industrial sewage, screened waste water and mud in the pumping stations. They can be used also to lift clear and dirty water and rain water.

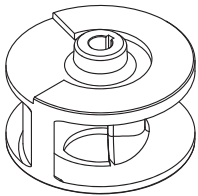

0010387 7/12/2012

SINGLE-CHANNEL IMPELLER

GENERAL FEATURES

		Materials/Constr.design
Single-channel impeller		Cast iron EN GJS400
External casing		Cast iron EN GJL250
Pump body		Cast iron EN GJL250
Cover		Cast iron EN GJL250
Mechanical seal	motor side	Graphite/Alumina
	pump side	Silicon carbide (SiC/SiC)
Motor shaft		Stainless steel AISI420
Power cable	Type	10 m SIRN8-F type
	100FWC-M-54-2,2T, 100FWC-M-54-3,1T	4G1,5+3x1mm ²
	100FWC-M-54-5,5T	4G2,5+3x1mm ²
		Motor
Constr.design		asynchronous squirrel cage-type in dry chamber
Type		4 poles; 50 Hz
Insulation class		F
Protection degree		IP68
Voltage	Three-phase	400V ±10%
Probe		Thermal in the winding
		Conductivity in the oil chamber
		Limits of use
Maximum liquid temperature		+40 °C
pH of pumped liquid		6 - 10
Liquid density		1,0 kg/dm ³
Maximum immersion depth:		5 m
Min. immersion depth for continuous service		517 mm
Free passage		80 mm
Max. number of starting/hour		20
		Construction options

- 60 Hz version
- Different voltages

DIMENSIONAL DRAWINGS

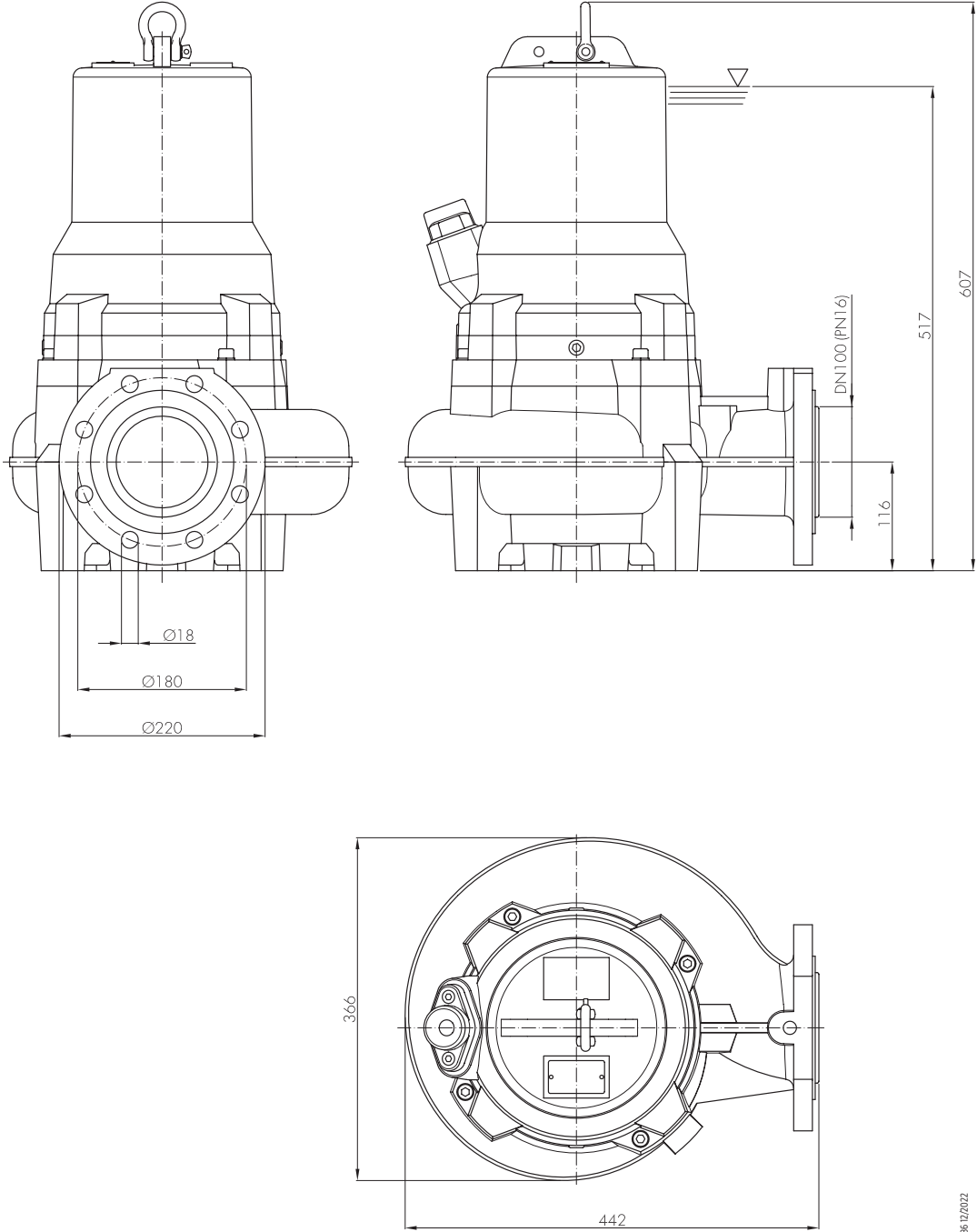

0030286 12/2022

Packaging		
Pump model	Dimensions [mm]	Weight [kg]
100FWC-M-54-2,2T	475x370x985	100
100FWC-M-54-3,1T	475x370x985	103
100FWC-M-54-5,5T	475x370x985	115

TECHNICAL DATA

Pump model	Motor absorbed power P ₁	Rated power P ₂		Voltage	Rated current	Phase	Power cable		float switch	Delivery port	Weight [kg]
	[kW]	[kW]	[HP]	[V]	[A]		length [m]	Type			
100FWC-M-54-2,2T	2,8	2,2	3	400	5,4	3 -	10	4G1,5+3x1	-	DN100	97
100FWC-M-54-3,1T	3,9	3,1	4,2	400	7,5	3 -	10	4G1,5+3x1	-	DN100	100
100FWC-M-54-5,5T	6,6	5,5	7,5	400	11,7	3 -	10	4G2,5+3x1	-	DN100	112

"-" = not available

• = available

HYDRAULIC PERFORMANCE AT 50 HZ

Pump model	Phase	Q = Delivery														
		l/sec 0	8	10	15	20	25	30	35	38	40	42,8	45	50	55	59
		m ³ /h 0	28,8	36	54	72	90	108	126	136,8	144	154,1	162	180	198	212,4
		US gpm 0	126,8	158,5	237,7	317	396,2	475,5	554,8	602,3	634	678,4	713,3	792,5	871,8	935,2
		H = Total meters head of water column [m]														
100FWC-M-54-2,2T	3 -	10,6	8,9	8,4	7,3	6,3	5,1	3,9	2,6	1,6						
100FWC-M-54-3,1T	3 -	12,7	11	10,5	9,4	8,4	7,2	6	4,5	3,6	3	2				
100FWC-M-54-5,5T	3 -	19	16	15,2	13,8	12,5	11,3	10,2	9,1	8,3	7,8	7,1	6,5	4,8	3	1,3

HYDRAULIC PERFORMANCE AT 50 HZ

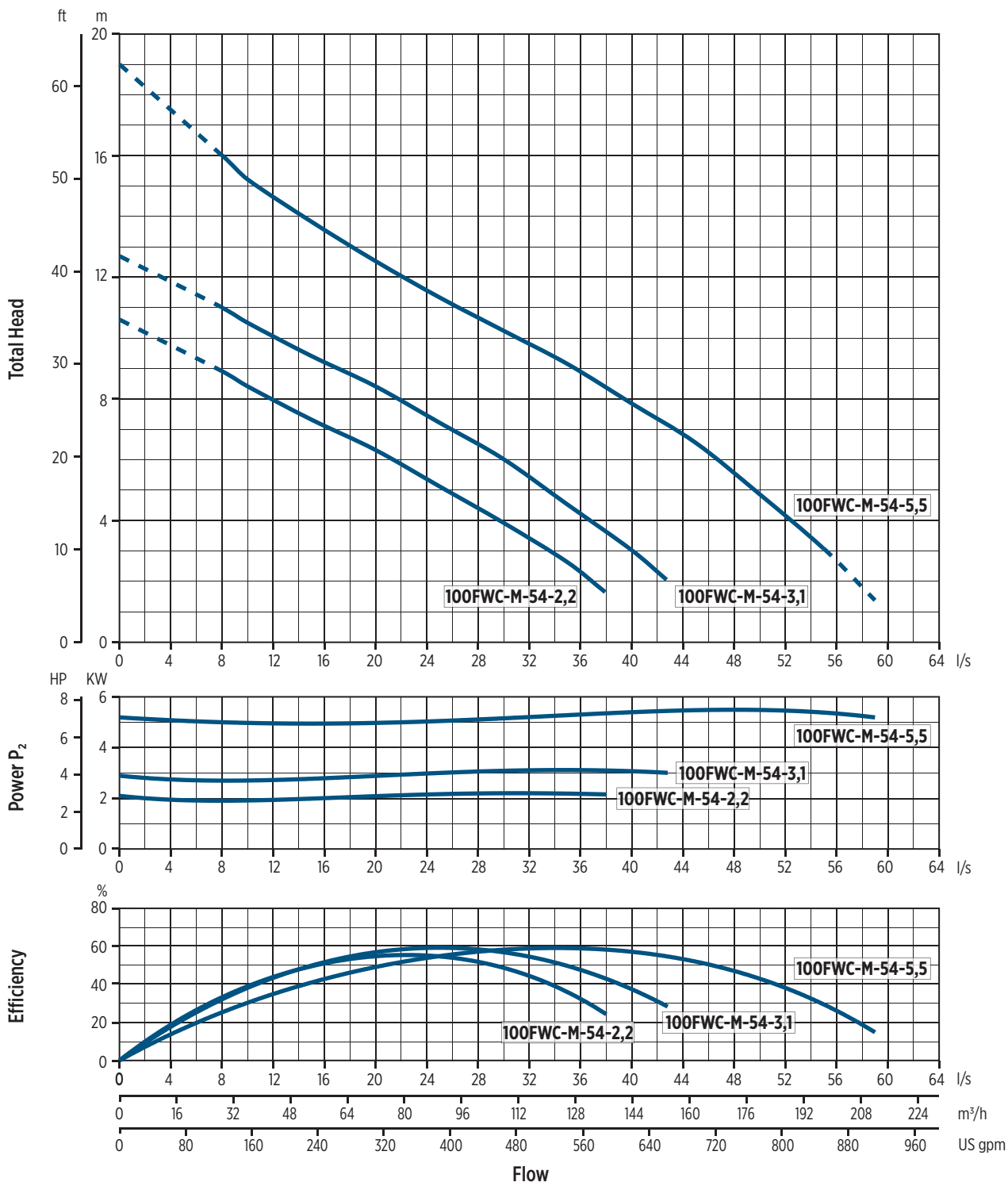

00201002 12/2022

INSTALLATION

INSTALLATION INSTRUCTIONS

PERMANENT INSTALLATION WITH COUPLING SYSTEM

It is the recommended installation for the permanent pumping station. The electric pump is guided by two pipes and it is connected automatically to the coupling system. The quick connection ensures that the pump can be easily removed and re-installed.

TRANSPORTABLE INSTALLATION

Transportable as emergency pump with connection to the hose and for free installation in the well.

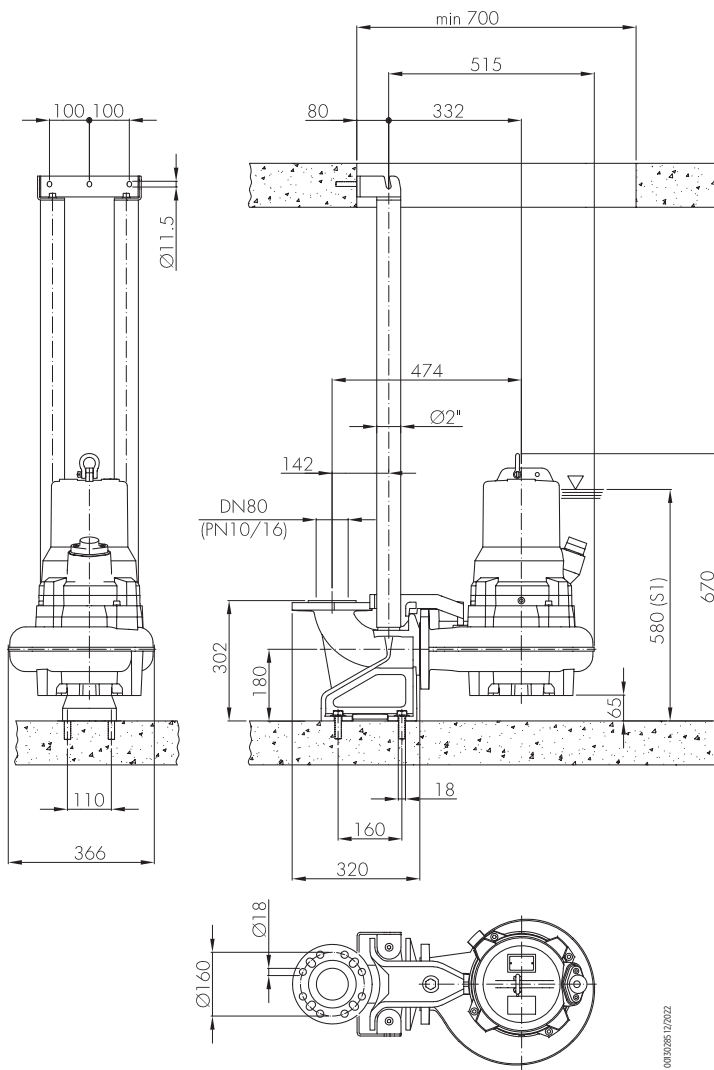

0050265/12/2022

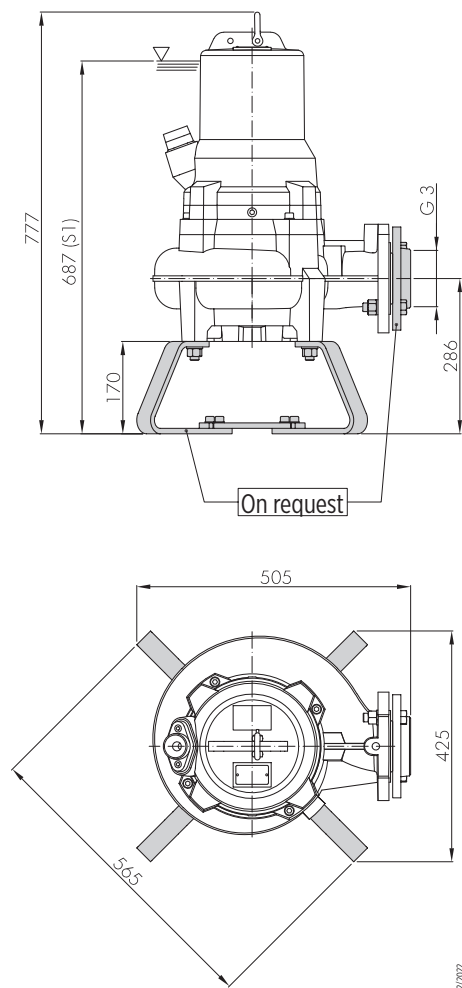

328517/2022